

**REFERENCE:**  
 "SITE PLAN, ASSESSOR'S PLAT 22-1 LOT 88, SITUATED ON FRANK AVENUE, SOUTH KINGSTOWN, RHODE ISLAND, PREPARED FOR 5A BUILDERS LLC, PREPARED BY DOWDELL ENGINEERING, INC., DATED: 6/5/19"

NOTE: THIS PLAN DEPICTS A RE-DESIGN OF THE FURNITURE FACILITY PERMITTED SITE PLAN LAST REVISED 6/1/2007 PREPARED FOR ART ARNOLD.

SITE PLAN CHANGES	6/1/2007 APPROVED SITE PLAN	CURRENT SITE PLAN
PAVEMENT	54,265 S.F.	47,465 S.F.
BUILDING	49,965 S.F.	46,020 S.F.
PARKING SPACES	32	30
LANDSCAPING	27,865 S.F.	27,865 S.F.
<b>GPQD REQUIREMENTS</b>	<b>20% OF 3.24 ACRES = 28,227 S.F. REQUIRED (32,444 S.F. PROVIDED)</b>	

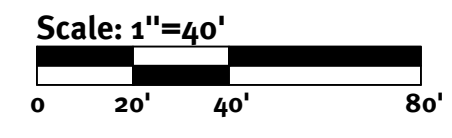
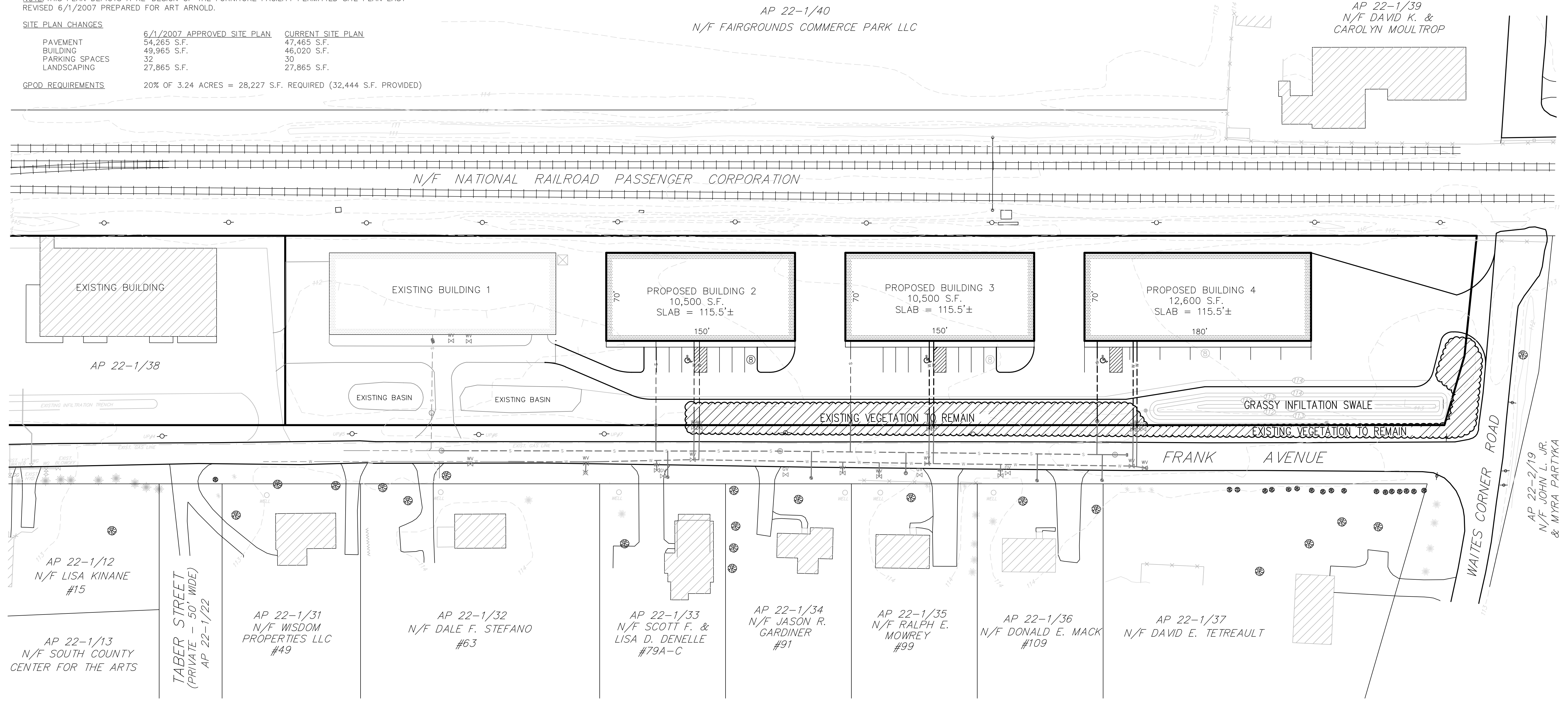

**DiPrete Engineering**

Two Stafford Court Cranston, RI 02920  
 tel 401-943-1000 fax 401-464-6006 www.diprete-eng.com

Boston • Providence • Newport

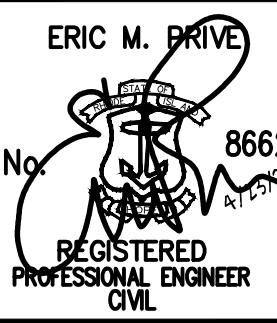

This regulatory submission set shall not be used for construction purposes unless stamped 'Issued for Construction' and signed by a DiPrete Engineering representative.

The contractor is responsible for all of the means, methods, safety precautions and requirements, and OSHA compliance in the implementation of this plan and design.

No.	Date	Description	By
1	03-23-2023	Site Plan Update: Building 2/3/4	J.A.R.
2	05-05-2017	Development Plan Submission	J.A.R.
3	05-05-2017	Development Plan Submission	J.A.R.

Drawn By: J.A.R. Design By: E.M.P.

**Site Plan**

**64 Frank Avenue**

Client:  
 AP 22-1 Lot 88  
 South Kingstown, Rhode Island  
**5A Builders**  
 Frank Ave Industrial Park, LLC  
 64 Frank Avenue  
 West Kingstown, RI 02882

DE Job No: 2199-001 Copyright 2024 by DiPrete Engineering Associates, Inc.

z:\deman\project\2199-001 Frank Avenue\autocad drawings\2199-001.dwg - building 2-3-4 updates 20240423.dwg Plotter: 4/23/2024