



STATE OF RHODE ISLAND
 Department of Environmental Management
 Office of Water Resources
 Email: dem.OWTS@dem.ri.gov
 Site Evaluation Form



Part A - Soil Profile Description

Application Number 2432-0705

Property Owner: Ann G Kelley Family Trust
 Property Location: 523 South Road, South Kingstown Plat: 47-3 Lot: 119
 Date of Test Hole: 6/28/24 Weather: 75°/Sunny Shaded: Yes No Time: 8:00
 Soil Evaluator: Ken Cole License Number: D4038
 Soil Evaluator email address: greenhillenv@yahoo.com

TH 1 Horizon	Depth	Horizon Boundaries		Soil Colors		Re-Dox		Texture	Structure	Consistence	Soil Category
		Dist	Topo	Matrix	Re-Dox Features	Ab.	S. Contr.				
Ap	0-10"	c	w	10YR ³ /2				st, bd Vfsl	2msblk	Fr	5
Bw	10-30"	c	w	10YR ⁶ /6				st, bd Vfsl	2msbk	Fr	5
C	30-47"	a	w	2.5Y ⁶ /2	2.5YR ⁴ /6	c	m j	Vfsl	om	Fr	7
2C	47-120"			2.5Y ⁶ /4				g, cb, st st/bs	om	Fr	6m
TH 2 Horizon	Depth	Horizon Boundaries		Soil Colors		Re-Dox		Texture	Structure	Consistence	Soil Category
		Dist	Topo	Matrix	Re-Dox Features	Ab.	S. Contr.				
Ap	0-12"	c	w	10YR ⁴ /3				st, bd Vfsl	2msbk	Fr	5
Bw	12-26"	c	w	10YR ⁶ /6				st, bd Vfsl	2msbk	Fr	5
C	26-53"	a	w	2.5Y ⁶ /2	2.5YR ⁴ /8	c	m p	Vfsl	om	Fr	7
2C	53-120"			2.5Y ⁵ /4				g, cb, st bd/s	om	Fr	6m

TH 1 Soil Class E01cuv Total Depth 120" Impervious/Limiting Layer Depth _____ (og) GW Seepage Depth _____ SHWT 96" (og)
 TH 2 Soil Class +Abati⁰¹ Total Depth 120" Impervious/Limiting Layer Depth _____ (og) GW Seepage Depth _____ SHWT 96" (og)

Comments: _____



STATE OF RHODE ISLAND
 Department of Environmental Management
 Office of Water Resources
 Email: dem.OWTS@dem.ri.gov
 Site Evaluation Form



Part A - Soil Profile Description

Application Number 2432-0705

Property Owner: Ann G. Kelley Family Trust
 Property Location: 523 South Road, South Kingstown Plat: 47-3 Lot: 119
 Date of Test Hole: 6/28/24 Weather: 75°/Sunny Shaded: Yes No Time: 9:00
 Soil Evaluator: Ken Cole License Number: D4038
 Soil Evaluator email address: greenhillenv@yahoo.com

TH <u>3</u> Horizon	Depth	Horizon Boundaries		Soil Colors		Re-Dox		Texture	Structure	Consistence	Soil Category
		Dist	Topo	Matrix	Re-Dox Features	Ab.	S. Contr.				
Ap	0-9"	c	w	10YR ^{3/2}				st, b v fs	2msdk	Fr	5
Bw	9-33"	c	w	10YR ^{5/6}				st, b v fs	2msdk	Fr	5
C	33-45"	a	w	2.5Y ^{4/2}	2.5YR ^{4/8}	c	m p	v fs	om	Fr	7
2C	45-120"			2.5Y ^{6/4}				st, b s	om	Fr	6m
TH <u>4</u> Horizon	Depth	Horizon Boundaries		Soil Colors		Re-Dox		Texture	Structure	Consistence	Soil Category
		Dist	Topo	Matrix	Re-Dox Features	Ab.	S. Contr.				
Ap	0-10"	c	w	10YR ^{3/2}				v fs	2msbk	Fr	5
Bw	10-27"	c	w	10YR ^{5/6}				v fs	2msbk	Fr	5
C	27-38"	a	w	2.5Y ^{6/2}	2.5YR ^{4/8}	c	m d	v fs	om	Fr	7
2C	38-120"			2.5Y ^{5/4}				st, b, st bd ls	om	Fr	6m

TH 3 Soil Class Eolian Total Depth 120" Impervious/Limiting Layer Depth _____ (og) GW Seepage Depth _____ SHWT 96" (og)
 TH 4 Soil Class Abolition Total Depth 120" Impervious/Limiting Layer Depth _____ (og) GW Seepage Depth _____ SHWT 96" (og)

Comments: _____



STATE OF RHODE ISLAND
 Department of Environmental Management
 Office of Water Resources
 Email: dem.OWTS@dem.ri.gov
 Site Evaluation Form



Part A - Soil Profile Description

Application Number 2432-0705

Property Owner: Ann G. Kelley Family Trust
 Property Location: 523 South Road, South Kingstown Plat: 47-3 Lot: 119
 Date of Test Hole: 6/28/24 Weather: 75°/cloudy Shaded: Yes No Time: 10:00
 Soil Evaluator: Ken Cole License Number: DA038
 Soil Evaluator email address: greenhillenv@yahoo.com

TH <u>5</u> Horizon	Depth	Horizon Boundaries		Soil Colors		Re-Dox		Texture	Structure	Consistence	Soil Category
		Dist	Topo	Matrix	Re-Dox Features	Ab.	S. Contr.				
Ap	0-9"	c	w	10YR ³ / ₂				Vfs1	2msbk	Fr	5
Bw	9-21"	c	w	10YR ⁵ / ₄				Vfs1	2msbk	Fr	5
C	21-48"	a	w	2.5Y ⁵ / ₂	2.5YR ⁴ / ₈	c	m d	Vfs1	om	Fr	7
2C	48-120"			2.5Y ⁵ / ₄				g,cb,st bd/s	om	Fr	6m
TH <u>6</u> Horizon	Depth	Horizon Boundaries		Soil Colors		Re-Dox		Texture	Structure	Consistence	Soil Category
		Dist	Topo	Matrix	Re-Dox Features	Ab.	S. Contr.				
Ap	0-10"	c	w	10YR ⁴ / ₃				st,bd Vfs1	2msbk	Fr	5
Bw	10-23"	c	w	10YR ⁵ / ₄				st,bd Vfs1	2msbk	Fr	5
C	23-51"	a	w	2.5Y ⁵ / ₂				Vfs1	om	Fr	7
2C	51-120"			2.5Y ⁵ / ₄				g,cb,st vbd/s	om	Fr	6m

TH 5 Soil Class Eptian Total Depth 120" Impervious/Limiting Layer Depth _____ (og) GW Seepage Depth _____ SHWT 96" (og)
 TH 6 Soil Class +Ablation till Total Depth 120" Impervious/Limiting Layer Depth _____ (og) GW Seepage Depth _____ SHWT 96" (og)

Comments: _____

Part B

Site Evaluation - to be completed by Soil Evaluator or Class II or III Designer

Please use the area below to locate:

1. Test holes and bedrock test holes,
2. Approximate direction of due north
3. Offsets from test holes to fixed points such as street, utility pole, or other permanent, marked object*
*OFFSETS MUST BE SHOWN

Key:

- Approximate location of test holes
- Approximate location of bedrock test holes
- Estimated gradient and direction of slope
- Approximate direction of due north

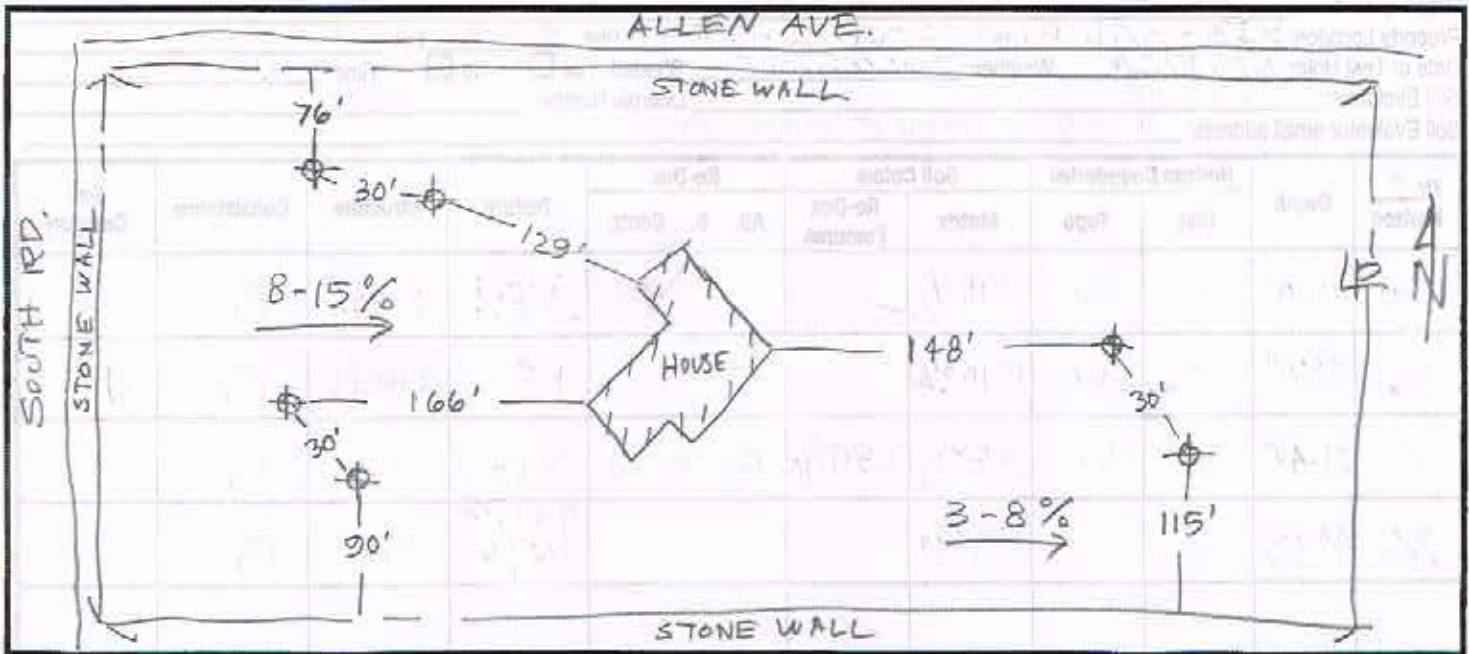

1. Relief and Slope: SEE ABOVE
2. Presence of any watercourse, wetlands or surface water bodies, within 200 feet of test holes: NO YES
3. Restrictive Layer or Bedrock within 4' below original ground within 25 feet of test hole. Provide all test hole locations & depths above. NO YES
4. Presence of existing or proposed private drinking water wells within 200 feet of test holes? If yes, locate on above sketch. NO YES
5. Public drinking water wells within 500 feet of test holes? If yes, locate on above sketch. NO YES
6. Is site within the watershed of a public drinking water reservoir or other critical area defined in Rule 6.42? NO YES
7. Has soil been excavated from or fill deposited on site? If yes, locate on above sketch. NO YES
8. Site's potential for flooding or ponding: NONE SLIGHT MODERATE SEVERE
9. Landscape position: MID SLOPE
10. Vegetation: WOODED
11. Indicate approximate location of property lines and roadways.
12. Additional comments, site constraints or additional information regarding site: _____

Certification

The undersigned hereby certifies that all information on this application and accompanying forms, submittals and sketches are true and accurate and that I have been authorized by the owner(s) to conduct these necessary field investigations and submit this request.

Part A prepared by: Kenneth R. Galo Signature License # DA038 Part B prepared by: Kenneth R. Galo Signature License # DA038

DO NOT WRITE IN THIS SPACE

Witnessed Soil Evaluation Decision: Concur Inconclusive Disclaim
Unwitnessed Soil Evaluation Decision: Accept Inconclusive Disclaim

Wet Season Determination required Additional Field Review Required

Explanation: _____

Signature Authorized Agent _____ Date _____



INSPECTION REPORT

APPLICATION NUMBER: 2432-0705

STREET: 523 South Road

INSPECTOR: Sutter

CITY/TOWN: South Kingstown

INSPECTION DATE: 06/28/2024

PLAT/LOT: 47-3 119

POLE NO:

OWTS INSTALLER: No installer/Unknown XXXXX Designer: D4038

ARRIVAL TIME:
WEATHER CONDITIONS:

PHONE NO: INSPECTION NUMBER: 0

TYPE OF INSPECTION:
Dry Season Inspection for Soil

Scheduled @ 10:30 AM

FINDINGS/COMMENTS

	<u>ESIGWT</u>	<u>TD</u>	
TH 1	96"	TBD	CAT GM
TH 2	96"	132"	
TH 3	96"	TBD	Loess over SB TILL
TH 4	96"	TBD	
TH 5	96"	120"	
TH 6	96"	120"	

RESULTS OF INSPECTION/ACTION REQUIRED

CONSTRUCTION - DESIGNER MUST INSPECT/APPROVE PRIOR TO DEM INSPECTION

- Bottom inspected
- Cover inspected
- Correct items listed
- (REI) Address items listed and call for re-inspection.
- (ASB) Designer must submit As-Builts
- (RPREQ) Redesign required. Submit new application.
- (RFAD) Stop Construction. Contact OWTS office. DO NOT CONTINUE.
- (COC) Designer submit COC
- (O&M) O&M agreement and permit must be recorded in Land Evidence Records.
- (Fee) A \$100.00 fee is required before re-inspection.
- Inspection waived

SITE TESTING

- Soil Evaluation - Concur
- Soil Evaluation - Do not concur
- Soil Evaluation - Inconclusive
- Alteration Test Hole - Verified
- Alteration Test Hole - Unacceptable
- Ledge Test
- Fill Tests
- Repair Test Hole

Signature of Inspector