

Part B

Site Evaluation - to be completed by Soil Evaluator or Class II or III Designer

Please use the area below to locate:

1. Test holes and bedrock test holes,
 2. Approximate direction of due north
 3. Offsets from test holes to fixed points such as street, utility pole, or other permanent, marked object*
- *OFFSETS MUST BE SHOWN

Key:

- Approximate location of test holes
- Approximate location of bedrock test holes
- Estimated gradient and direction of slope
- Approximate direction of due north

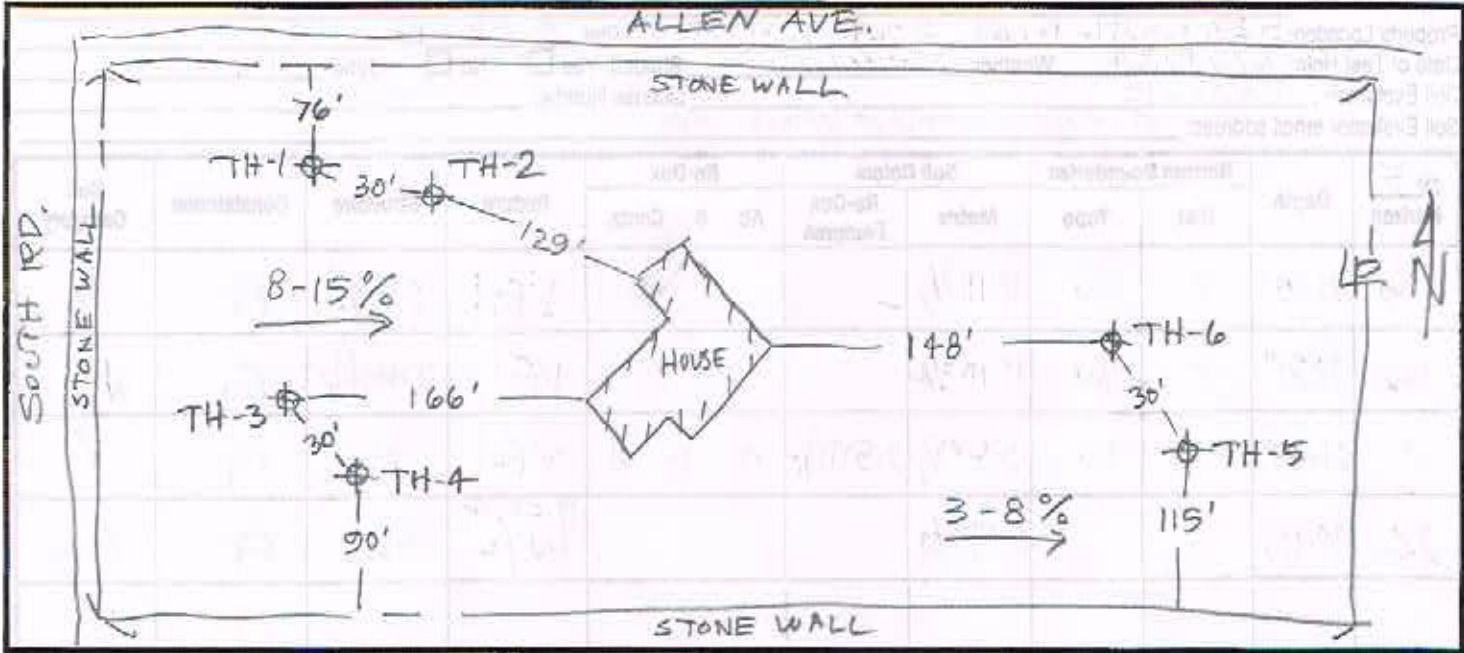

1. Relief and Slope: SEE ABOVE
2. Presence of any watercourse, wetlands or surface water bodies, within 200 feet of test holes: NO YES
3. Restrictive Layer or Bedrock within 4' below original ground within 25 feet of test hole. Provide all test hole locations & depths above. NO YES
4. Presence of existing or proposed private drinking water wells within 200 feet of test holes? If yes, locate on above sketch. NO YES
5. Public drinking water wells within 500 feet of test holes? If yes, locate on above sketch. NO YES
6. Is site within the watershed of a public drinking water reservoir or other critical area defined in Rule 6.42? NO YES
7. Has soil been excavated from or fill deposited on site? If yes, locate on above sketch. NO YES
8. Site's potential for flooding or ponding: NONE SLIGHT MODERATE SEVERE
9. Landscape position: MID SLOPE
10. Vegetation: WOODED
11. Indicate approximate location of property lines and roadways.
12. Additional comments, site constraints or additional information regarding site:

Certification

The undersigned hereby certifies that all information on this application and accompanying forms, submittals and sketches are true and accurate and that I have been authorized by the owner(s) to conduct these necessary field investigations and submit this request.

Part A prepared by: Kenneth R. Galt, D4038 Signature License # Part B prepared by: Kenneth R. Galt, D4038 Signature

DO NOT WRITE IN THIS SPACE

Witnessed Soil Evaluation Decision: Concur Inconclusive Disclaim
 Unwitnessed Soil Evaluation Decision: Accept Inconclusive Disclaim

Wet Season Determination required Additional Field Review Required

Explanatoin: _____

Signature Authorized Agent _____ Date _____