



D-Series Size 1 LED Area Luminaire



Catalog Number
Notes
Type

Hit the Tab key or mouse over the page to see all interactive elements.

d#series

Specifications

EPA:	0.69 ft ² (0.06 m ²)
Length:	32.71" (83.1 cm)
Width:	14.26" (36.2 cm)
Height H1:	7.88" (20.0 cm)
Height H2:	2.73" (6.9 cm)
Weight:	34 lbs (15.4 kg)

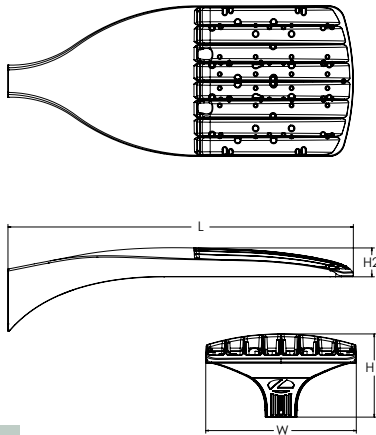

ds Design Select options indicated by this color background.

Introduction

The modern styling of the D-Series features a highly refined aesthetic that blends seamlessly with its environment. The D-Series offers the benefits of the latest in LED technology into a high performance, high efficacy, long-life luminaire.

The photometric performance results in sites with excellent uniformity, greater pole spacing and lower power density. D-Series outstanding photometry aids in reducing the number of poles required in area lighting applications with typical energy savings of 65% and expected service life of over 100,000 hours.



Items marked by a shaded background qualify for the Design Select program and ship in 15 days or less. To learn more about Design Select, visit www.acuitybrands.com/designselect.
*See ordering tree for details

Ordering Information

EXAMPLE: DSX1 LED P7 40K 70CRI T3M MVOLT SPA NLTAIR2 PIRHN DDBXD

Series	LEDs	Color temperature ²	Color Rendering Index ²	Distribution	Voltage	Mounting
DSX1 LED	Forward optics	(this section 70CRI only)		AFR Automotive front row	TSM Type V medium	Shipped included
	P1 P6	30K 3000K	70CRI	T1S Type I short	TSLG Type V low glare	SPA Square pole mounting (#8 drilling)
	P2 P7	40K 4000K	70CRI	T2M Type II medium	T5W Type V wide	RPA Round pole mounting (#8 drilling)
	P3 P8	50K 5000K	70CRI	T3M Type III medium	BLC3 Type III backlight control ³	SPA5 Square pole mounting #5 drilling ⁹
	P4 P9			T3LG Type III low glare ³	BLC4 Type IV backlight control ³	RPA5 Round pole mounting #5 drilling ⁹
	P5	27K 2700K	80CRI	T4M Type IV medium	LCCO Left corner cutoff ³	SPA8N Square narrow pole mounting #8 drilling
	Rotated optics	30K 3000K	80CRI	T4LG Type IV low glare ³	RCCO Right corner cutoff ³	WBA Wall bracket ¹⁰
	P10 ¹ P12 ¹	35K 3500K	80CRI	TFTM Forward throw medium		MA Mast arm adapter (mounts on 2 3/8" OD horizontal tenon)
	P11 ¹ P13 ¹	40K 4000K	80CRI			
		50K 5000K	80CRI			

Control options	Other options	Finish (required)
Shipped installed	Shipped installed	DDBXD Dark Bronze
NLTAIR2 PIRHN nLight AIR gen 2 enabled with bi-level motion / ambient sensor, 8-40' mounting height, ambient sensor enabled at 2fc. ^{11, 12, 20, 21}	SPD20KV 20KV surge protection	DBLXD Black
PIR High/low, motion/ambient sensor, 8-40' mounting height, ambient sensor enabled at 2fc. ^{13, 20, 21}	HS Houseside shield (black finish standard) ²²	DNAXD Natural Aluminum
PER NEMA twist-lock receptacle only (controls ordered separately) ¹⁴	L90 Left rotated optics ¹	DWHXD White
PER5 Five-pin receptacle only (controls ordered separate) ^{14, 21}	R90 Right rotated optics ¹	DDBTXD Textured dark bronze
PER7 Seven-pin receptacle only (controls ordered separate) ^{14, 21}	CCE Coastal Construction ²³	DBLBXD Textured black
FAO Field adjustable output ^{15, 21}	HA 50°C ambient operation ²⁴	DNATXD Textured natural aluminum
BL30 Bi-level switched dimming, 30% ^{16, 21}	BAA Buy America(n) Act and/or Build America Buy America Qualified	DWHGXD Textured white
BL50 Bi-level switched dimming, 50% ^{16, 21}	SF Single fuse (120, 277, 347V) ²⁵	
DMG 0-10v dimming wires pulled outside fixture (for use with an external control, ordered separately) ¹⁷	DF Double fuse (208, 240, 480V) ²⁶	
DS Dual switching ^{18, 19, 21}	Shipped separately	
	EGSR External Glare Shield (reversible, field install required, matches housing finish)	
	BSDB Bird Spikes (field install required)	



Ordering Information

Accessories

Ordered and shipped separately.

DLL127F 1.5 JU	Photocell - SSL twist-lock (120-277V) ²⁵
DLL347F 1.5 CUL JU	Photocell - SSL twist-lock (347V) ²⁵
DLL480F 1.5 CUL JU	Photocell - SSL twist-lock (480V) ²⁵
DSHORT SBK	Shorting cap ²⁵
DSX1HS P#	House-side shield (enter package number 1-13 in place of #)
DSXRPA (FINISH)	Round pole adapter (#8 drilling, specify finish)
DSXSPA5 (FINISH)	Square pole adapter #5 drilling (specify finish)
DSXSPA5 (FINISH)	Round pole adapter #5 drilling (specify finish)
DSX1EGSR (FINISH)	External glare shield (specify finish)
DSX1BSDB (FINISH)	Bird spike deterrent bracket (specify finish)

NOTES

- Rotated optics available with packages P10, P11, P12 and P13. Must be combined with option L90 or R90.
- 30K, 40K, and 50K available in 70CRI and 80CRI. 27K and 35K only available with 80CRI. Contact Technical Support for other possible combinations.
- T3LG, T4LG, BLC3, BLC4, LCCO, RCCO not available with option HS.
- MVOLT driver operates on any line voltage from 120-277V (50/60 Hz).
- HVOLT driver operates on any line voltage from 347-480V (50/60 Hz).
- HVOLT not available with package P1 and P10 when combined with option NLTAIR2 PIRHN or option PIR.
- XVOLT operates with any voltage between 277V and 480V (50/60 Hz).
- XVOLT not available in packages P1 or P10. XVOLT not available with P1, P2, P5, P7, P9, P10, P11 and P13 when combined with option NLTAIR2 PIRHN or PIR. XVOLT not available with fusing (SF or DF).
- SPA5 and RPA5 for use with #5 drilling only (Not for use with #8 drilling).
- WBA cannot be combined with Type 5 distributions plus photocell (PER).
- NLTAIR2 and PIRHN must be ordered together. For more information on nLight AIR2 visit this [link](#)
- NLTAIR2 PIRHN not available with other controls including PIR, PER, PER5, PER7, FAO, BL30, BL50, DMG and DS. NLTAIR2 PIRHN not available with P1 and P10 using HVOLT.
- PIR not available with NLTAIR2 PIRHN, PER, PER5, PER7, FAO BL30, BL50, DMG and DS.
- PER/PER5/PER7 not available with NLTAIR2 PIRHN, PIR, BL30, BL50, FAO, DMG and DS. Photocell ordered and shipped as a separate line item from Acuity Brands Controls. See accessories. Shorting Cap included.
- FAO not available with other dimming control options NLTAIR2 PIRHN, PIR, PER5, PER7, BL30, BL50, DMG and DS.
- BL30 and BL50 are not available with NLTAIR2 PIRHN, PIR, PER, PER5, PER7, FAO, DMG and DS. BL30 or BL50 must specify 120 or 277V.
- DMG not available with NLTAIR2 PIRHN, PIR, PER, PER5, PER7, BL30, BL50, FAO and DS.
- DS not available with NLTAIR2 PIRHN, PIR, PER, PER5, PER7, BL30, BL50, FAO and DMG.
- DS requires (2) separately switched circuits. DS provides 50/50 fixture operation via (2) different sets of leads using (2) drivers. DS only available with packages P8, P9, P10, P11, P12 and P13.
- Reference Motion Sensor Default Settings table on page 4 to see functionality.
- Reference Controls Options table on page 4.
- HS not available with T3LG, T4LG, BLC3, BLC4, LCCO and RCCO distribution. Also available as a separate accessory; see Accessories information.
- CCE option not available with option BS and EGSR. Contact Technical Support for availability.
- Option HA not available with performance packages P4, P5, P7, P8, P9 and P13.
- Requires luminaire to be specified with PER, PER5 or PER7 option. See Controls Table on page 4.
- Single fuse (SF) requires 120V, 277V, or 347V. Double fuse (DF) requires 208V, 240V or 480V. XVOLT not available with fusing (SF or DF).

Shield Accessories



External Glare Shield (EGSR)

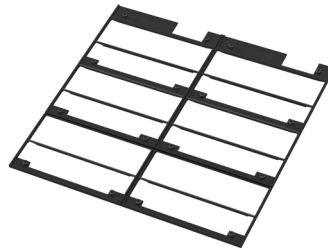

House Side Shield (HS)

Drilling

HANDHOLE ORIENTATION

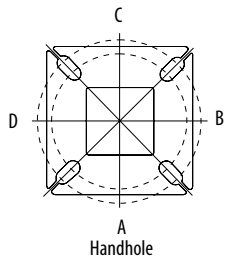

Handhole

Template #8

1.75" for aluminum poles
2.75" for other pole types

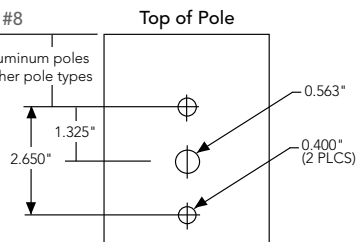

Tenon Mounting Slipfitter

Tenon O.D.	Mounting	Single Unit	2 @ 180	2 @ 90	3 @ 90	3 @ 120	4 @ 90
2-3/8"	RPA	AS3-5 190	AS3-5 280	AS3-5 290	AS3-5 390	AS3-5 320	AS3-5 490
2-7/8"	RPA	AST25-190	AST25-280	AST25-290	AST25-390	AST25-320	AST25-490
4"	RPA	AST35-190	AST35-280	AST35-290	AST35-390	AST35-320	AST35-490

Mounting Option	Drilling Template	Single	2 @ 180	2 @ 90	3 @ 90	3 @ 120	4 @ 90
Head Location		Side B	Side B & D	Side B & C	Side B, C & D	Round Pole Only	Side A, B, C & D
Drill Nomenclature	#8	DM19AS	DM28AS	DM29AS	DM39AS	DM32AS	DM49AS
Minimum Acceptable Outside Pole Dimension							
SPA	#8	3.5"	3.5"	3.5"	3.5"		3.5"
RPA	#8	3"	3"	3"	3"	3"	3"
SPA5	#5	3"	3"	3"	3"		3"
RPA5	#5	3"	3"	3"	3"	3"	3"
SPA8N	#8	3"	3"	3"	3"		3"

DSX1 Area Luminaire - EPA

*Includes luminaire and integral mounting arm. Other tenons, arms, brackets or other accessories are not included in this EPA data.

Fixture Quantity & Mounting Configuration	Single DM19	2 @ 180 DM28	2 @ 90 DM29	3 @ 90 DM39	3 @ 120 DM32	4 @ 90 DM49
Mounting Type						
DSX1 with SPA	0.69	1.38	1.23	1.54	---	1.58
DSX1 with SPA5, SPA8N	0.70	1.40	1.30	1.66	---	1.68
DSX1 with RPA, RPA5	0.70	1.40	1.30	1.66	1.60	1.68
DSX1 with MA	0.83	1.66	1.50	2.09	2.09	2.09

Photometric Diagrams

To see complete photometric reports or download .ies files for this product, visit Lithonia Lighting's [homepage](#).

Isofootcandle plots for the DSX1 LED P9 40K 70CRI. Distances are in units of mounting height (25').



Performance Data

Lumen Ambient Temperature (LAT) Multipliers

Use these factors to determine relative lumen output for average ambient temperatures from 0-40°C (32-104°F).

Ambient		Lumen Multiplier
0°C	32°F	1.04
5°C	41°F	1.04
10°C	50°F	1.03
15°C	59°F	1.02
20°C	68°F	1.01
25°C	77°C	1.00
30°C	86°F	0.99
35°C	95°F	0.98
40°C	104°F	0.97

Projected LED Lumen Maintenance

Data references the extrapolated performance projections for the platforms noted in a **25°C ambient**, based on 10,000 hours of LED testing (tested per IESNA LM-80-08 and projected per IESNA TM-21-11).

To calculate LLF, use the lumen maintenance factor that corresponds to the desired number of operating hours below. For other lumen maintenance values, contact factory.

Operating Hours	Lumen Maintenance Factor
0	1.00
25,000	0.95
50,000	0.90
100,000	0.81

FAO Dimming Settings

FAO Position	% Wattage	% Lumen Output
8	100%	100%
7	93%	95%
6	80%	85%
5	66%	73%
4	54%	61%
3	41%	49%
2	29%	36%
1	15%	20%

*Note: Calculated values are based on original performance package data. When calculating new values for given FAO position, use maximum published values by package listed on specification sheet (input watts and lumens by optic type).

Motion Sensor Default Settings

Option	Unoccupied Dimmed Level	High Level (when occupied)	Photocell Operation	Dwell Time	Ramp-up Time	Dimming Fade Rate
PIR	30%	100%	Enabled @ 2FC	7.5 min	3 sec	5 min
NLTAIR2 PIRHN	30%	100%	Enabled @ 2FC	7.5 min	3 sec	5 min

Controls Options

Nomenclature	Description	Functionality	Primary control device	Notes
FAO	Field adjustable output device installed inside the luminaire; wired to the driver dimming leads.	Allows the luminaire to be manually dimmed, effectively trimming the light output.	FAO device	Cannot be used with other controls options that need the 0-10V leads
DS (not available on DSX0)	Drivers wired independently for 50/50 luminaire operation	The luminaire is wired to two separate circuits, allowing for 50/50 operation.	Independently wired drivers	Requires two separately switched circuits. Consider nLight AIR as a more cost effective alternative.
PERS or PER7	Twist-lock photocell receptacle	Compatible with standard twist-lock photocells for dusk to dawn operation, or advanced control nodes that provide 0-10V dimming signals.	Twist-lock photocells such as DLL Elite or advanced control nodes such as ROAM.	Pins 4 & 5 to dimming leads on driver, Pins 6 & 7 are capped inside luminaire. Cannot be used with other controls options that need the 0-10V leads.
PIR	Motion sensor with integral photocell. Sensor suitable for 8' to 40' mounting height.	Luminaires dim when no occupancy is detected.	Acuity Controls rSBG	Cannot be used with other controls options that need the 0-10V leads.
NLTAIR2 PIRHN	nLight AIR enabled luminaire for motion sensing, photocell and wireless communication.	Motion and ambient light sensing with group response. Scheduled dimming with motion sensor over-ride when wirelessly connected to the nLight Elypse.	nLight Air rSBG	nLight AIR sensors can be programmed and commissioned from the ground using the CIAIRity Pro app. Cannot be used with other controls options that need the 0-10V leads.
BL30 or BL50	Integrated bi-level device that allows a second control circuit to switch all light engines to either 30% or 50% light output	BLC device provides input to 0-10V dimming leads on all drivers providing either 100% or dimmed (30% or 50%) control by a secondary circuit	BLC UVOLT1	BLC device is powered off the 0-10V dimming leads, thus can be used with any input voltage from 120 to 480V

Electrical Load

	Performance Package	LED Count	Drive Current (mA)	Wattage	Current (A)					
					120V	208V	240V	277V	347V	480V
Forward Optics (Non-Rotated)	P1	30	530	51	0.42	0.24	0.21	0.18	0.15	0.11
	P2	30	700	68	0.56	0.33	0.28	0.24	0.20	0.14
	P3	30	1050	104	0.85	0.49	0.43	0.37	0.29	0.21
	P4	30	1250	125	1.03	0.60	0.52	0.45	0.36	0.26
	P5	30	1400	142	1.15	0.66	0.58	0.50	0.40	0.29
	P6	40	1250	167	1.38	0.79	0.69	0.60	0.48	0.34
	P7	40	1400	188	1.54	0.89	0.77	0.67	0.53	0.38
	P8	60	1100	216	1.80	1.04	0.90	0.78	0.62	0.45
	P9	60	1400	279	2.31	1.33	1.15	1.00	0.80	0.58
Rotated Optics (Requires L90 or R90)	P10	60	530	101	0.84	0.49	0.42	0.37	0.29	0.21
	P11	60	700	135	1.12	0.65	0.56	0.49	0.39	0.28
	P12	60	1050	206	1.72	0.99	0.86	0.74	0.59	0.43
	P13	60	1400	279	2.30	1.33	1.15	1.00	0.79	0.57

LED Color Temperature / Color Rendering Multipliers

	70 CRI		80CRI		90CRI	
	Lumen Multiplier	Availability	Lumen Multiplier	Availability	Lumen Multiplier	Availability
5000K	102%	Standard	92%	Extended lead-time	71%	(see note)
4000K	100%	Standard	92%	Extended lead-time	67%	(see note)
3500K	100%	(see note)	90%	Extended lead-time	63%	(see note)
3000K	96%	Standard	87%	Extended lead-time	61%	(see note)
2700K	94%	(see note)	85%	Extended lead-time	57%	(see note)

Note: Some LED types are available as per special request. Contact Technical Support for more information.

Performance Data

Lumen Output

Lumen values are from photometric tests performed in accordance with IESNA LM-79-08. Data is considered to be representative of configurations shown within the tolerances described within LM-79. Contact factory for performance data on any configurations not shown here.

Forward Optics																			
Performance Package	System Watts	LED Count	Drive Current (mA)	Distribution Type	30K					40K					50K				
					(3000K, 70 CRI)					(4000K, 70 CRI)					(5000K, 70 CRI)				
					Lumens	B	U	G	LPW	Lumens	B	U	G	LPW	Lumens	B	U	G	LPW
P1	51W	30	530	T1S	7,776	1	0	2	153	8,104	1	0	2	159	8,262	1	0	2	162
				T2M	7,203	1	0	3	142	7,507	2	0	3	147	7,653	2	0	3	150
				T3M	7,287	1	0	3	143	7,594	1	0	3	149	7,742	1	0	3	152
				T3LG	6,509	1	0	1	128	6,783	1	0	1	133	6,916	1	0	1	136
				T4M	7,395	1	0	3	145	7,707	1	0	3	151	7,857	1	0	3	154
				T4LG	6,726	1	0	1	132	7,010	1	0	1	138	7,146	1	0	1	140
				TFTM	7,446	1	0	3	146	7,760	1	0	3	152	7,912	1	0	3	155
				T5M	7,609	3	0	2	149	7,930	3	0	2	156	8,084	3	0	2	159
				T5W	7,732	3	0	2	152	8,058	4	0	2	158	8,215	4	0	2	161
				T5LG	7,631	3	0	1	150	7,953	3	0	1	156	8,108	3	0	1	159
				BLC3	5,300	0	0	2	104	5,524	0	0	2	109	5,631	0	0	2	111
				BLC4	5,474	0	0	3	108	5,705	0	0	3	112	5,816	0	0	3	114
				RCCO	5,348	0	0	2	105	5,573	0	0	2	109	5,682	0	0	2	112
				LCCO	5,348	0	0	2	105	5,573	0	0	2	109	5,682	0	0	2	112
				AFR	7,776	1	0	2	153	8,104	1	0	2	159	8,262	1	0	2	162
				P2	68W	30	700	T1S	9,997	1	0	2	147	10,418	1	0	2	154	10,621
T2M	9,260	2	0					3	137	9,651	2	0	3	142	9,839	2	0	3	145
T3M	9,368	2	0					3	138	9,763	2	0	3	144	9,953	2	0	3	147
T3LG	8,368	1	0					2	123	8,721	1	0	2	129	8,891	1	0	2	131
T4M	9,507	2	0					3	140	9,909	2	0	3	146	10,102	2	0	3	149
T4LG	8,647	1	0					2	128	9,012	1	0	2	133	9,187	1	0	2	136
TFTM	9,573	2	0					3	141	9,977	2	0	3	147	10,172	2	0	3	150
T5M	9,782	4	0					2	144	10,195	4	0	2	150	10,393	4	0	2	153
T5W	9,940	4	0					2	147	10,360	4	0	2	153	10,562	4	0	2	156
T5LG	9,810	3	0					1	145	10,224	3	0	1	151	10,423	3	0	1	154
BLC3	6,814	0	0					2	101	7,101	0	0	2	105	7,240	0	0	2	107
BLC4	7,038	0	0					3	104	7,334	0	0	3	108	7,477	0	0	3	110
RCCO	6,875	1	0					2	101	7,165	1	0	2	106	7,305	1	0	2	108
LCCO	6,875	1	0					2	101	7,165	1	0	2	106	7,305	1	0	2	108
AFR	9,997	1	0					2	147	10,418	1	0	2	154	10,621	1	0	2	157
P3	102W	30	1050					T1S	14,093	2	0	2	138	14,687	2	0	2	144	14,973
				T2M	13,055	2	0	3	128	13,605	2	0	3	133	13,871	2	0	3	136
				T3M	13,206	2	0	4	129	13,763	2	0	4	135	14,031	2	0	4	137
				T3LG	11,797	2	0	2	115	12,294	2	0	2	120	12,534	2	0	2	123
				T4M	13,403	2	0	4	131	13,968	2	0	4	137	14,241	2	0	4	139
				T4LG	12,190	2	0	2	119	12,704	2	0	2	124	12,952	2	0	2	127
				TFTM	13,496	2	0	4	132	14,065	2	0	4	138	14,339	2	0	4	140
				T5M	13,790	4	0	2	135	14,371	4	0	2	141	14,652	4	0	2	143
				T5W	14,013	4	0	3	137	14,605	4	0	3	143	14,889	4	0	3	146
				T5LG	13,830	3	0	2	135	14,413	3	0	2	141	14,694	3	0	2	144
				BLC3	9,606	0	0	2	94	10,011	0	0	2	98	10,206	0	0	2	100
				BLC4	9,921	0	0	3	97	10,340	0	0	3	101	10,541	0	0	3	103
				RCCO	9,692	1	0	2	95	10,101	1	0	2	99	10,298	1	0	2	101
				LCCO	9,692	1	0	2	95	10,101	1	0	2	99	10,298	1	0	2	101
				AFR	14,093	2	0	2	138	14,687	2	0	2	144	14,973	2	0	2	147

Performance Data

Lumen Output

Lumen values are from photometric tests performed in accordance with IESNA LM-79-08. Data is considered to be representative of configurations shown within the tolerances described within LM-79. Contact factory for performance data on any configurations not shown here.

Forward Optics

Performance Package	System Watts	LED Count	Drive Current (mA)	Distribution Type	30K					40K					50K				
					(3000K, 70 CRI)					(4000K, 70 CRI)					(5000K, 70 CRI)				
					Lumens	B	U	G	LPW	Lumens	B	U	G	LPW	Lumens	B	U	G	LPW
P4	124W	30	1250	T1S	16,416	2	0	3	132	17,109	2	0	3	138	17,442	2	0	3	141
				T2M	15,207	3	0	4	123	15,849	3	0	4	128	16,158	3	0	4	130
				T3M	15,383	2	0	4	124	16,032	2	0	4	129	16,345	2	0	4	132
				T3LG	13,742	2	0	2	111	14,321	2	0	2	116	14,600	2	0	2	118
				T4M	15,613	2	0	4	126	16,272	2	0	4	131	16,589	2	0	4	134
				T4LG	14,200	2	0	2	115	14,799	2	0	2	119	15,087	2	0	2	122
				TFTM	15,721	2	0	4	127	16,384	2	0	4	132	16,703	2	0	4	135
				T5M	16,063	4	0	2	130	16,741	4	0	2	135	17,067	4	0	2	138
				T5W	16,324	5	0	3	132	17,013	5	0	3	137	17,344	5	0	3	140
				T5LG	16,110	3	0	2	130	16,790	4	0	2	135	17,117	4	0	2	138
				BLC3	11,190	0	0	3	90	11,662	0	0	3	94	11,889	0	0	3	96
				BLC4	11,557	0	0	3	93	12,044	0	0	3	97	12,279	0	0	3	99
				RCCO	11,291	1	0	3	91	11,767	1	0	3	95	11,996	1	0	3	97
				LCCO	11,291	1	0	3	91	11,767	1	0	3	95	11,996	1	0	3	97
				AFR	16,416	2	0	3	132	17,109	2	0	3	138	17,442	2	0	3	141
				P5	138W	30	1400	T1S	18,052	2	0	3	131	18,814	2	0	3	136	19,180
T2M	16,723	3	0					4	121	17,428	3	0	4	126	17,768	3	0	4	129
T3M	16,917	3	0					4	122	17,630	3	0	4	128	17,974	3	0	4	130
T3LG	15,111	2	0					2	109	15,749	2	0	2	114	16,055	2	0	2	116
T4M	17,169	3	0					5	124	17,893	3	0	5	130	18,242	3	0	5	132
T4LG	15,615	2	0					2	113	16,274	2	0	2	118	16,591	2	0	2	120
TFTM	17,288	2	0					4	125	18,017	2	0	5	130	18,368	3	0	5	133
T5M	17,664	5	0					3	128	18,410	5	0	3	133	18,768	5	0	3	136
T5W	17,951	5	0					3	130	18,708	5	0	3	135	19,073	5	0	3	138
T5LG	17,716	4	0					2	128	18,463	4	0	2	134	18,823	4	0	2	136
BLC3	12,305	0	0					3	89	12,824	0	0	3	93	13,074	0	0	3	95
BLC4	12,709	0	0					4	92	13,245	0	0	4	96	13,503	0	0	4	98
RCCO	12,416	1	0					3	90	12,940	1	0	3	94	13,192	1	0	3	95
LCCO	12,416	1	0					3	90	12,940	1	0	3	94	13,192	1	0	3	95
AFR	18,052	2	0					3	131	18,814	2	0	3	136	19,180	2	0	3	139
P6	165W	40	1250					T1S	21,031	2	0	3	127	21,918	2	0	3	133	22,345
				T2M	19,482	3	0	4	118	20,303	3	0	4	123	20,699	3	0	4	125
				T3M	19,708	3	0	5	119	20,539	3	0	5	124	20,939	3	0	5	127
				T3LG	17,604	2	0	2	107	18,347	2	0	2	111	18,704	2	0	2	113
				T4M	20,001	3	0	5	121	20,845	3	0	5	126	21,251	3	0	5	129
				T4LG	18,191	2	0	2	110	18,959	2	0	2	115	19,328	2	0	2	117
				TFTM	20,140	3	0	5	122	20,989	3	0	5	127	21,398	3	0	5	129
				T5M	20,579	5	0	3	125	21,447	5	0	3	130	21,865	5	0	3	132
				T5W	20,912	5	0	3	127	21,795	5	0	3	132	22,219	5	0	3	134
				T5LG	20,638	4	0	2	125	21,509	4	0	2	130	21,928	4	0	2	133
				BLC3	14,335	0	0	3	87	14,940	0	0	3	90	15,231	0	0	3	92
				BLC4	14,805	0	0	4	90	15,430	0	0	4	93	15,731	0	0	4	95
				RCCO	14,464	1	0	3	88	15,074	1	0	3	91	15,368	1	0	3	93
				LCCO	14,464	1	0	3	88	15,074	1	0	3	91	15,368	1	0	3	93
				AFR	21,031	2	0	3	127	21,918	2	0	3	133	22,345	2	0	3	135

Performance Data

Lumen Output

Lumen values are from photometric tests performed in accordance with IESNA LM-79-08. Data is considered to be representative of configurations shown within the tolerances described within LM-79. Contact factory for performance data on any configurations not shown here.

Forward Optics																							
Performance Package	System Watts	LED Count	Drive Current (mA)	Distribution Type	30K					40K					50K								
					(3000K, 70 CRI)					(4000K, 70 CRI)					(5000K, 70 CRI)								
					Lumens	B	U	G	LPW	Lumens	B	U	G	LPW	Lumens	B	U	G	LPW				
P7	184W	40	1400	T1S	22,741	2	0	3	123	23,700	2	0	3	129	24,162	3	0	3	131				
				T2M	21,066	3	0	4	114	21,955	3	0	4	119	22,383	3	0	4	121				
				T3M	21,311	3	0	5	116	22,210	3	0	5	120	22,642	3	0	5	123				
				T3LG	19,036	2	0	2	103	19,839	2	0	3	108	20,226	2	0	3	110				
				T4M	21,628	3	0	5	117	22,541	3	0	5	122	22,980	3	0	5	125				
				T4LG	19,671	2	0	2	107	20,501	2	0	3	111	20,900	2	0	3	113				
				TFTM	21,778	3	0	5	118	22,697	3	0	5	123	23,139	3	0	5	125				
				T5M	22,252	5	0	3	121	23,191	5	0	3	126	23,643	5	0	3	128				
				T5W	22,613	5	0	3	123	23,567	5	0	4	128	24,027	5	0	4	130				
				T5LG	22,317	4	0	2	121	23,258	4	0	2	126	23,712	4	0	2	129				
				BLC3	15,501	0	0	3	84	16,155	0	0	4	88	16,470	0	0	4	89				
				BLC4	16,010	0	0	4	87	16,685	0	0	4	90	17,010	0	0	4	92				
				RCCO	15,641	1	0	3	85	16,301	1	0	3	89	16,619	1	0	3	90				
				LCCO	15,641	1	0	3	85	16,301	1	0	3	89	16,619	1	0	3	90				
				AFR	22,741	2	0	3	123	23,700	2	0	3	129	24,162	3	0	3	131				
				P8	216W	60	1100	T1S	28,701	3	0	3	133	29,912	3	0	4	139	30,495	3	0	4	141
								T2M	26,587	3	0	5	123	27,709	3	0	5	128	28,249	3	0	5	131
T3M	26,895	3	0					5	125	28,030	3	0	5	130	28,576	3	0	5	132				
T3LG	24,025	3	0					3	111	25,038	3	0	3	116	25,526	3	0	3	118				
T4M	27,296	3	0					5	127	28,448	3	0	5	132	29,002	3	0	5	134				
T4LG	24,826	3	0					3	115	25,873	3	0	3	120	26,378	3	0	3	122				
TFTM	27,485	3	0					5	127	28,645	3	0	5	133	29,203	3	0	5	135				
T5M	28,084	5	0					4	130	29,269	5	0	4	136	29,839	5	0	4	138				
T5W	28,539	5	0					4	132	29,743	5	0	4	138	30,323	5	0	4	141				
T5LG	28,165	4	0					2	131	29,354	4	0	2	136	29,926	4	0	2	139				
BLC3	19,563	0	0					4	91	20,388	0	0	4	94	20,786	0	0	4	96				
BLC4	20,205	0	0					5	94	21,057	0	0	5	98	21,468	0	0	5	99				
RCCO	19,740	1	0					4	91	20,572	1	0	4	95	20,973	1	0	4	97				
LCCO	19,740	1	0					4	91	20,572	1	0	4	95	20,973	1	0	4	97				
AFR	28,701	3	0					3	133	29,912	3	0	4	139	30,495	3	0	4	141				
P9	277W	60	1400					T1S	34,819	3	0	4	126	36,288	3	0	4	131	36,996	3	0	4	134
								T2M	32,255	3	0	5	116	33,616	3	0	5	121	34,271	3	0	5	124
				T3M	32,629	3	0	5	118	34,006	3	0	5	123	34,668	3	0	5	125				
				T3LG	29,146	3	0	3	105	30,376	3	0	4	110	30,968	3	0	4	112				
				T4M	33,116	3	0	5	120	34,513	3	0	5	125	35,185	3	0	5	127				
				T4LG	30,119	3	0	3	109	31,389	3	0	4	113	32,001	3	0	4	116				
				TFTM	33,345	3	0	5	120	34,751	3	0	5	125	35,429	3	0	5	128				
				T5M	34,071	5	0	4	123	35,509	5	0	4	128	36,201	5	0	4	131				
				T5W	34,624	5	0	4	125	36,084	5	0	4	130	36,788	5	0	4	133				
				T5LG	34,170	5	0	3	123	35,612	5	0	3	129	36,306	5	0	3	131				
				BLC3	23,734	0	0	4	86	24,735	0	0	4	89	25,217	0	0	4	91				
				BLC4	24,513	0	0	5	88	25,547	0	0	5	92	26,045	0	0	5	94				
				RCCO	23,948	1	0	4	86	24,958	1	0	4	90	25,445	1	0	4	92				
				LCCO	23,948	1	0	4	86	24,958	1	0	4	90	25,445	1	0	4	92				
				AFR	34,819	3	0	4	126	36,288	3	0	4	131	36,996	3	0	4	134				

Performance Data

Lumen Output

Lumen values are from photometric tests performed in accordance with IESNA LM-79-08. Data is considered to be representative of configurations shown within the tolerances described within LM-79. Contact factory for performance data on any configurations not shown here.

Rotated Optics																							
Performance Package	System Watts	LED Count	Drive Current (mA)	Distribution Type	30K					40K					50K								
					(3000K, 70 CRI)					(4000K, 70 CRI)					(5000K, 70 CRI)								
					Lumens	B	U	G	LPW	Lumens	B	U	G	LPW	Lumens	B	U	G	LPW				
P10	101W	60	530	T1S	15,164	3	0	3	150	15,803	3	0	3	156	16,112	3	0	3	159				
				T2M	14,047	4	0	4	139	14,640	4	0	4	145	14,925	4	0	4	147				
				T3M	14,208	4	0	4	140	14,807	4	0	4	146	15,096	4	0	4	149				
				T3LG	12,693	3	0	3	125	13,229	3	0	3	131	13,487	3	0	3	133				
				T4M	14,420	4	0	4	142	15,028	4	0	4	148	15,321	4	0	4	151				
				T4LG	13,115	3	0	3	129	13,668	3	0	3	135	13,934	3	0	3	138				
				TFTM	14,522	4	0	4	143	15,134	4	0	4	149	15,429	4	0	4	152				
				T5M	14,836	4	0	2	146	15,462	4	0	2	153	15,763	4	0	2	156				
				T5W	15,076	4	0	3	149	15,712	5	0	3	155	16,019	5	0	3	158				
				T5LG	14,879	3	0	2	147	15,507	3	0	2	153	15,809	3	0	2	156				
				BLC3	10,335	3	0	3	102	10,771	4	0	4	106	10,981	4	0	4	108				
				BLC4	10,674	4	0	4	105	11,124	4	0	4	110	11,341	4	0	4	112				
				RCCO	10,429	1	0	2	103	10,869	1	0	2	107	11,080	1	0	2	109				
				LCCO	10,429	1	0	2	103	10,869	1	0	2	107	11,080	1	0	2	109				
				AFR	15,164	3	0	3	150	15,803	3	0	3	156	16,112	3	0	3	159				
				P11	135W	60	700	T1S	19,437	4	0	4	144	20,257	4	0	4	150	20,651	4	0	4	153
								T2M	18,005	4	0	4	133	18,765	4	0	4	139	19,131	4	0	4	142
T3M	18,211	4	0					4	135	18,980	4	0	4	141	19,350	4	0	4	143				
T3LG	16,270	3	0					3	121	16,957	3	0	3	126	17,287	4	0	4	128				
T4M	18,483	4	0					4	137	19,263	5	0	5	143	19,638	5	0	5	146				
T4LG	16,810	3	0					3	125	17,519	3	0	3	130	17,861	3	0	3	132				
TFTM	18,614	4	0					4	138	19,399	4	0	4	144	19,777	5	0	5	147				
T5M	19,017	5	0					3	141	19,819	5	0	3	147	20,205	5	0	3	150				
T5W	19,325	5	0					3	143	20,140	5	0	3	149	20,533	5	0	3	152				
T5LG	19,072	4	0					2	141	19,876	4	0	2	147	20,264	4	0	2	150				
BLC3	13,247	4	0					4	98	13,806	4	0	4	102	14,075	4	0	4	104				
BLC4	13,682	4	0					4	101	14,259	4	0	4	106	14,537	4	0	4	108				
RCCO	13,367	1	0					3	99	13,931	1	0	3	103	14,203	1	0	3	105				
LCCO	13,367	1	0					3	99	13,931	1	0	3	103	14,203	1	0	3	105				
AFR	19,437	4	0					4	144	20,257	4	0	4	150	20,651	4	0	4	153				
P12	206W	60	1050					T1S	27,457	4	0	4	133	28,616	4	0	4	139	29,174	4	0	4	142
								T2M	25,436	5	0	5	124	26,509	5	0	5	129	27,025	5	0	5	131
				T3M	25,727	5	0	5	125	26,812	5	0	5	130	27,335	5	0	5	133				
				T3LG	22,984	4	0	4	112	23,954	4	0	4	116	24,421	4	0	4	119				
				T4M	26,110	5	0	5	127	27,212	5	0	5	132	27,742	5	0	5	135				
				T4LG	23,747	4	0	4	115	24,749	4	0	4	120	25,231	4	0	4	123				
				TFTM	26,295	5	0	5	128	27,404	5	0	5	133	27,938	5	0	5	136				
				T5M	26,864	5	0	4	130	27,997	5	0	4	136	28,543	5	0	4	139				
				T5W	27,299	5	0	4	133	28,451	5	0	4	138	29,006	5	0	4	141				
				T5LG	26,942	4	0	2	131	28,078	4	0	2	136	28,626	4	0	2	139				
				BLC3	18,714	4	0	4	91	19,504	4	0	4	95	19,884	4	0	4	97				
				BLC4	19,327	5	0	5	94	20,143	5	0	5	98	20,535	5	0	5	100				
				RCCO	18,883	1	0	4	92	19,680	1	0	4	96	20,064	1	0	4	97				
				LCCO	18,883	1	0	4	92	19,680	1	0	4	96	20,064	1	0	4	97				
				AFR	27,457	4	0	4	133	28,616	4	0	4	139	29,174	4	0	4	142				
				P13	276W	60	1400	T1S	34,436	5	0	5	125	35,889	5	0	5	130	36,588	5	0	5	133
								T2M	31,900	5	0	5	116	33,246	5	0	5	121	33,894	5	0	5	123
T3M	32,265	5	0					5	117	33,626	5	0	5	122	34,282	5	0	5	124				
T3LG	28,826	4	0					4	105	30,042	4	0	4	109	30,628	4	0	4	111				
T4M	32,746	5	0					5	119	34,128	5	0	5	124	34,793	5	0	5	126				
T4LG	29,782	4	0					4	108	31,039	4	0	4	113	31,644	5	0	4	115				
TFTM	32,978	5	0					5	120	34,369	5	0	5	125	35,039	5	0	5	127				
T5M	33,692	5	0					4	122	35,113	5	0	4	127	35,797	5	0	4	130				
T5W	34,238	5	0					4	124	35,682	5	0	4	129	36,378	5	0	4	132				
T5LG	33,789	5	0					3	122	35,215	5	0	3	128	35,901	5	0	3	130				
BLC3	23,471	5	0					5	85	24,461	5	0	5	89	24,937	5	0	5	90				
BLC4	24,240	5	0					5	88	25,262	5	0	5	92	25,755	5	0	5	93				
RCCO	23,683	1	0					4	86	24,682	1	0	4	89	25,163	1	0	4	91				
LCCO	23,683	1	0					4	86	24,682	1	0	4	89	25,163	1	0	4	91				
AFR	34,436	5	0					5	125	35,889	5	0	5	130	36,588	5	0	5	133				

Dimensions

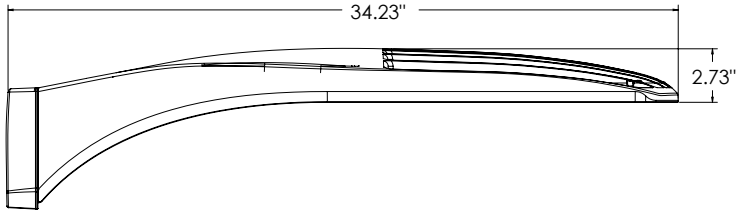

DSX1 with RPA, RPA5, SPA5, SPA8N mount
Weight: 36 lbs

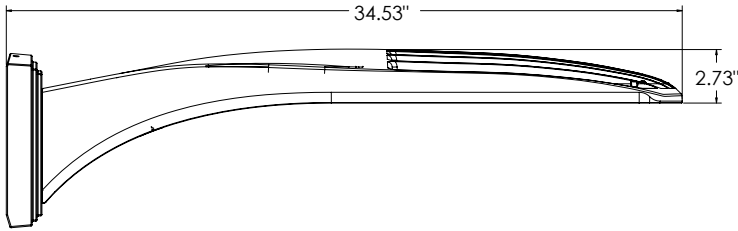
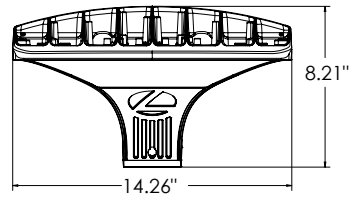

DSX1 with WBA mount
Weight: 38 lbs

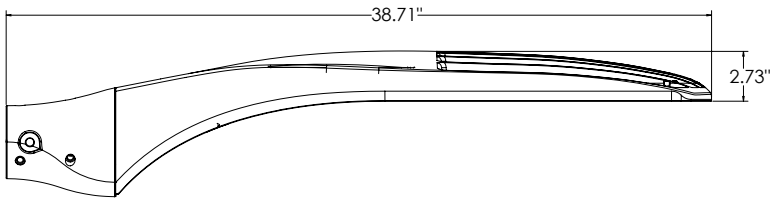
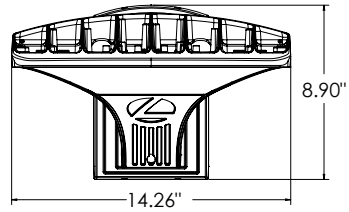

DSX1 with MA mount
Weight: 39 lbs

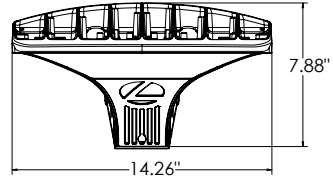

SPA (STANDARD ARM)

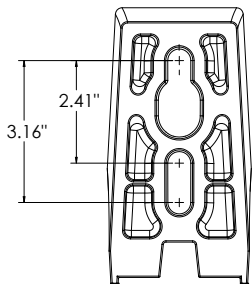

RPA

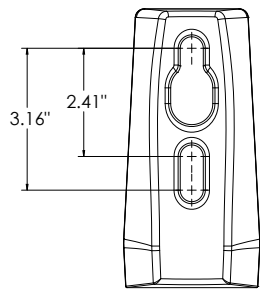

SPA5

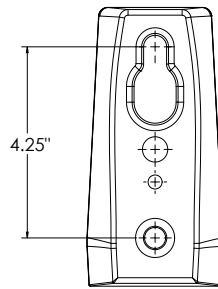

RPA5

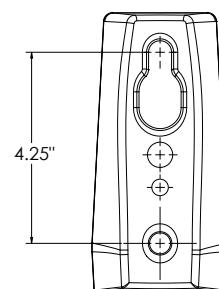

SPA8N

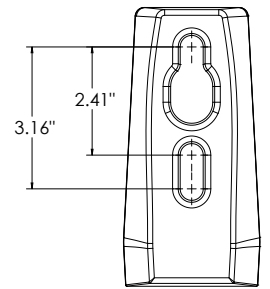

nLight Sensor Coverage Pattern

NLTAIR2 PIRHN

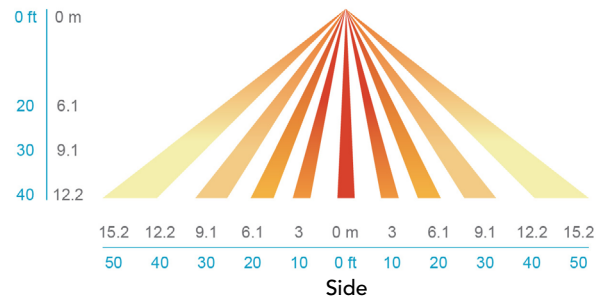
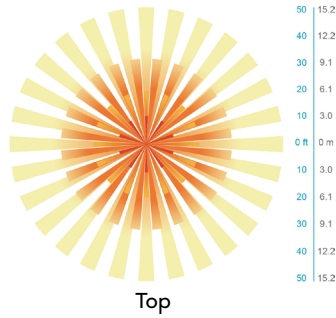

FEATURES & SPECIFICATIONS

INTENDED USE

The sleek design of the D-Series Size 1 reflects the embedded high performance LED technology. It is ideal for many commercial and municipal applications, such as parking lots, plazas, campuses, and streetscapes.

CONSTRUCTION

Single-piece die-cast aluminum housing has integral heat sink fins to optimize thermal management through conductive and convective cooling. Modular design allows for ease of maintenance and future light engine upgrades. The LED drivers are mounted in direct contact with the casting to promote low operating temperature and long life. Housing driver compartment is completely sealed against moisture and environmental contaminants (IP66). Vibration rated per ANSI C136.31 for 3G for SPA and MA. 1.5G for mountings RPA, RPA5, SPA5 and SPA8N. Low EPA (0.69 ft²) for optimized pole wind loading.

FINISH

Exterior parts are protected by a zinc-infused Super Durable TGIC thermoset powder coat finish that provides superior resistance to corrosion and weathering. A tightly controlled multi-stage process ensures a minimum 3 mils thickness for a finish that can withstand extreme climate changes without cracking or peeling. Available in both textured and non-textured finishes.

Coastal Construction (CCE)

Optional corrosion resistant construction is engineered with added corrosion protection in materials and/or pre-treatment of base material under super durable paint. Provides additional corrosion protection for applications near coastal areas. Finish is salt spray tested to over 5,000 hours per ASTM B117 with scribe rating of 10. Additional lead-times may apply.

OPTICS

Precision-molded proprietary silicone lenses are engineered for superior area lighting distribution, uniformity, and pole spacing. Light engines are available in standard 3000 K, 4000 K and 5000 K (70 CRI) configurations. 80CRI configurations are also available. The D-Series Size 1 has zero uplight and qualifies as a Nighttime Friendly™ product, meaning it is consistent with the LEED® and Green Globes™ criteria for eliminating wasteful uplight.

ELECTRICAL

Light engine configurations consist of high-efficacy LEDs mounted to metal-core circuit boards to maximize heat dissipation and promote long life (up to L81/100,000 hours at 25°C). Class 1 electronic drivers are designed to have a power factor >90%, THD <20%, and an expected life of 100,000 hours with <1% failure rate. Easily serviceable 10kV surge protection device meets a minimum Category C Low operation (per ANSI/IEEE C62.41.2).

STANDARD CONTROLS

The DSX1 LED area luminaire has a number of control options. DSX Size 1, comes standard with 0-10V dimming drivers. Dusk to dawn controls can be utilized via optional NEMA twist-lock photocell receptacles. Integrated motion sensor with on-board photocells feature field-adjustable programming and are suitable for mounting heights up to 40 feet. Control option BL features a bi-level device that allows a second control circuit to switch all light engines to either 30% or 50% light output.

nLIGHT AIR CONTROLS

The DSX1 LED area luminaire is also available with nLight® AIR for the ultimate in wireless control. This powerful controls platform provides out-of-the-box basic motion sensing and photocontrol functionality and is suitable for mounting heights up to 40 feet. Once commissioned using a smartphone and the easy-to-use CLAIRITY app, nLight AIR equipped luminaires can be grouped, resulting in motion sensor and photocell group response without the need for additional equipment. Scheduled dimming with motion sensor over-ride can be achieved when used with the nLight Eclipse. Additional information about nLight Air can be found here.

INSTALLATION

Integral mounting arm allows for fast mounting using Lithonia standard #8 drilling and accommodates pole drilling's from 2.41 to 3.12" on center. The standard "SPA" option for square poles and the "RPA" option for round poles use the #8 drilling. For #5 pole drillings, use SPA5 or RPA5. Additional mountings are available including a wall bracket (WBA) and mast arm (MA) option that allows luminaire attachment to a 2 3/8" horizontal mast arm.

LISTINGS

UL listed to meet U.S. and Canadian standards. UL Listed for wet locations. Light engines are IP66 rated; luminaire is IP66 rated. Rated for -40°C minimum ambient.

DesignLights Consortium® (DLC) Premium qualified product and DLC qualified product. Not all versions of this product may be DLC Premium qualified or DLC qualified. Please check the DLC Qualified Products List at www.designlights.org/QPL to confirm which versions are qualified.

International Dark-Sky Association (IDA) Fixture Seal of Approval (FSA) is available for all products on this page utilizing 3000K color temperature only.

GOVERNMENT PROCUREMENT

BAA – Buy America(n) Act: Product with the BAA option qualifies as a domestic end product under the Buy American Act as implemented in the FAR and DFARS. Product with the BAA option also qualifies as manufactured in the United States under DOT Buy America regulations.

BABA – Build America Buy America: Product with the BAA option also qualifies as produced in the United States under the definitions of the Build America, Buy America Act.

Please refer to www.acuitybrands.com/buy-american for additional information.

WARRANTY

5-year limited warranty. This is the only warranty provided and no other statements in this specification sheet create any warranty of any kind. All other express and implied warranties are disclaimed. Complete warranty terms located at: www.acuitybrands.com/support/warranty/terms-and-conditions

Note: Actual performance may differ as a result of end-user environment and application. All values are design or typical values, measured under laboratory conditions at 25 °C. Specifications subject to change without notice.



D-Series Size 1 LED Area Luminaire



d#series

Specifications

EPA:	0.69 ft ² (0.06 m ²)
Length:	32.71" (83.1 cm)
Width:	14.26" (36.2 cm)
Height H1:	7.88" (20.0 cm)
Height H2:	2.73" (6.9 cm)
Weight:	34 lbs (15.4 kg)

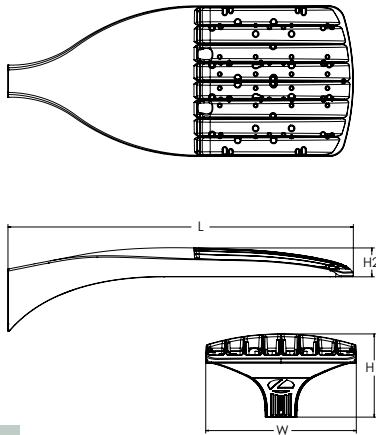

ds Design Select options indicated by this color background.

Catalog Number
Notes
Type

Hit the Tab key or mouse over the page to see all interactive elements.

Introduction

The modern styling of the D-Series features a highly refined aesthetic that blends seamlessly with its environment. The D-Series offers the benefits of the latest in LED technology into a high performance, high efficacy, long-life luminaire.

The photometric performance results in sites with excellent uniformity, greater pole spacing and lower power density. D-Series outstanding photometry aids in reducing the number of poles required in area lighting applications with typical energy savings of 65% and expected service life of over 100,000 hours.



Items marked by a shaded background qualify for the Design Select program and ship in 15 days or less. To learn more about Design Select, visit www.acuitybrands.com/designselect.
*See ordering tree for details

Ordering Information

EXAMPLE: DSX1 LED P7 40K 70CRI T3M MVOLT SPA NLTAIR2 PIRHN DDBXD

Series	LEDs	Color temperature ²	Color Rendering Index ²	Distribution	Voltage	Mounting
DSX1 LED	Forward optics	(this section 70CRI only)				
	P1 P6	30K 3000K	70CRI	AFR Automotive front row	TSM Type V medium	Shipped included
	P2 P7	40K 4000K	70CRI	T1S Type I short	TSLG Type V low glare	SPA Square pole mounting (#8 drilling)
	P3 P8	50K 5000K	70CRI	T2M Type II medium	T5W Type V wide	RPA Round pole mounting (#8 drilling)
	P4 P9			T3M Type III medium	BLC3 Type III backlight control ³	SPA5 Square pole mounting #5 drilling ⁹
	P5	27K 2700K	80CRI	T3LG Type III low glare ³	BLC4 Type IV backlight control ³	RPA5 Round pole mounting #5 drilling ⁹
	Rotated optics	30K 3000K	80CRI	T4M Type IV medium		SPA8N Square narrow pole mounting #8 drilling
	P10 ¹ P12 ¹	35K 3500K	80CRI	T4LG Type IV low glare ³	LCCO Left corner cutoff ³	WBA Wall bracket ¹⁰
	P11 ¹ P13 ¹	40K 4000K	80CRI	TFTM Forward throw medium	RCCO Right corner cutoff ³	MA Mast arm adapter (mounts on 2 3/8" OD horizontal tenon)
		50K 5000K	80CRI			

Control options	Other options	Finish (required)
Shipped installed	Shipped installed	DDBXD Dark Bronze
NLTAIR2 PIRHN nLight AIR gen 2 enabled with bi-level motion / ambient sensor, 8-40' mounting height, ambient sensor enabled at 2fc. ^{11, 12, 20, 21}	SPD20KV 20KV surge protection	DBLXD Black
PIR High/low, motion/ambient sensor, 8-40' mounting height, ambient sensor enabled at 2fc. ^{13, 20, 21}	HS Houseside shield (black finish standard) ²²	DNAXD Natural Aluminum
PER NEMA twist-lock receptacle only (controls ordered separately) ¹⁴	L90 Left rotated optics ¹	DWHXD White
PER5 Five-pin receptacle only (controls ordered separate) ^{14, 21}	R90 Right rotated optics ¹	DDBTXD Textured dark bronze
PER7 Seven-pin receptacle only (controls ordered separate) ^{14, 21}	CCE Coastal Construction ²³	DBLBXD Textured black
FAO Field adjustable output ^{15, 21}	HA 50°C ambient operation ²⁴	DNATXD Textured natural aluminum
BL30 Bi-level switched dimming, 30% ^{16, 21}	BAA Buy America(n) Act and/or Build America Buy America Qualified	DWHGXD Textured white
BL50 Bi-level switched dimming, 50% ^{16, 21}	SF Single fuse (120, 277, 347V) ²⁵	
DMG 0-10v dimming wires pulled outside fixture (for use with an external control, ordered separately) ¹⁷	DF Double fuse (208, 240, 480V) ²⁶	
DS Dual switching ^{18, 19, 21}	Shipped separately	
	EGSR External Glare Shield (reversible, field install required, matches housing finish)	
	BSDB Bird Spikes (field install required)	



Ordering Information

Accessories

Ordered and shipped separately.

DLL127F 1.5 JU	Photocell - SSL twist-lock (120-277V) ²⁵
DLL347F 1.5 CUL JU	Photocell - SSL twist-lock (347V) ²⁵
DLL480F 1.5 CUL JU	Photocell - SSL twist-lock (480V) ²⁵
DSHORT SBK	Shorting cap ²⁵
DSX1HS P#	House-side shield (enter package number 1-13 in place of #)
DSXRPA (FINISH)	Round pole adapter (#8 drilling, specify finish)
DSXSPA5 (FINISH)	Square pole adapter #5 drilling (specify finish)
DSXSPA5 (FINISH)	Round pole adapter #5 drilling (specify finish)
DSX1EGSR (FINISH)	External glare shield (specify finish)
DSX1BSDB (FINISH)	Bird spike deterrent bracket (specify finish)

NOTES

- Rotated optics available with packages P10, P11, P12 and P13. Must be combined with option L90 or R90.
- 30K, 40K, and 50K available in 70CRI and 80CRI. 27K and 35K only available with 80CRI. Contact Technical Support for other possible combinations.
- T3LG, T4LG, BLC3, BLC4, LCCO, RCCO not available with option HS.
- MVOLT driver operates on any line voltage from 120-277V (50/60 Hz).
- HVOLT driver operates on any line voltage from 347-480V (50/60 Hz).
- HVOLT not available with package P1 and P10 when combined with option NLTAIR2 PIRHN or option PIR.
- XVOLT operates with any voltage between 277V and 480V (50/60 Hz).
- XVOLT not available in packages P1 or P10. XVOLT not available with P1, P2, P5, P7, P9, P10, P11 and P13 when combined with option NLTAIR2 PIRHN or PIR. XVOLT not available with fusing (SF or DF).
- SPA5 and RPA5 for use with #5 drilling only (Not for use with #8 drilling).
- WBA cannot be combined with Type 5 distributions plus photocell (PER).
- NLTAIR2 and PIRHN must be ordered together. For more information on nLight AIR2 visit this [link](#)
- NLTAIR2 PIRHN not available with other controls including PIR, PER, PER5, PER7, FAO, BL30, BL50, DMG and DS. NLTAIR2 PIRHN not available with P1 and P10 using HVOLT.
- PIR not available with NLTAIR2 PIRHN, PER, PER5, PER7, FAO BL30, BL50, DMG and DS.
- PER/PER5/PER7 not available with NLTAIR2 PIRHN, PIR, BL30, BL50, FAO, DMG and DS. Photocell ordered and shipped as a separate line item from Acuity Brands Controls. See accessories. Shorting Cap included.
- FAO not available with other dimming control options NLTAIR2 PIRHN, PIR, PER5, PER7, BL30, BL50, DMG and DS.
- BL30 and BL50 are not available with NLTAIR2 PIRHN, PIR, PER, PER5, PER7, FAO, DMG and DS. BL30 or BL50 must specify 120 or 277V.
- DMG not available with NLTAIR2 PIRHN, PIR, PER, PER5, PER7, BL30, BL50, FAO and DS.
- DS not available with NLTAIR2 PIRHN, PIR, PER, PER5, PER7, BL30, BL50, FAO and DMG.
- DS requires (2) separately switched circuits. DS provides 50/50 fixture operation via (2) different sets of leads using (2) drivers. DS only available with packages P8, P9, P10, P11, P12 and P13.
- Reference Motion Sensor Default Settings table on page 4 to see functionality.
- Reference Controls Options table on page 4.
- HS not available with T3LG, T4LG, BLC3, BLC4, LCCO and RCCO distribution. Also available as a separate accessory; see Accessories information.
- CCE option not available with option BS and EGSR. Contact Technical Support for availability.
- Option HA not available with performance packages P4, P5, P7, P8, P9 and P13.
- Requires luminaire to be specified with PER, PER5 or PER7 option. See Controls Table on page 4.
- Single fuse (SF) requires 120V, 277V, or 347V. Double fuse (DF) requires 208V, 240V or 480V. XVOLT not available with fusing (SF or DF).

Shield Accessories



External Glare Shield (EGSR)

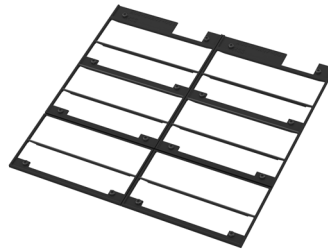

House Side Shield (HS)

Drilling

HANDHOLE ORIENTATION

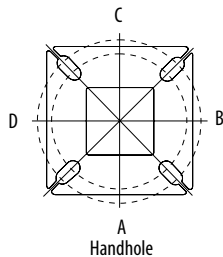

Handhole

Template #8

1.75" for aluminum poles
2.75" for other pole types

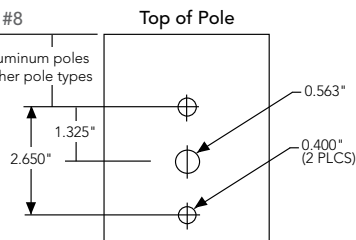

Tenon Mounting Slipfitter

Tenon O.D.	Mounting	Single Unit	2 @ 180	2 @ 90	3 @ 90	3 @ 120	4 @ 90
2-3/8"	RPA	AS3-5 190	AS3-5 280	AS3-5 290	AS3-5 390	AS3-5 320	AS3-5 490
2-7/8"	RPA	AST25-190	AST25-280	AST25-290	AST25-390	AST25-320	AST25-490
4"	RPA	AST35-190	AST35-280	AST35-290	AST35-390	AST35-320	AST35-490

Mounting Option	Drilling Template	Single	2 @ 180	2 @ 90	3 @ 90	3 @ 120	4 @ 90
Head Location		Side B	Side B & D	Side B & C	Side B, C & D	Round Pole Only	Side A, B, C & D
Drill Nomenclature	#8	DM19AS	DM28AS	DM29AS	DM39AS	DM32AS	DM49AS
Minimum Acceptable Outside Pole Dimension							
SPA	#8	3.5"	3.5"	3.5"	3.5"		3.5"
RPA	#8	3"	3"	3"	3"	3"	3"
SPA5	#5	3"	3"	3"	3"		3"
RPA5	#5	3"	3"	3"	3"	3"	3"
SPA8N	#8	3"	3"	3"	3"		3"

DSX1 Area Luminaire - EPA

*Includes luminaire and integral mounting arm. Other tenons, arms, brackets or other accessories are not included in this EPA data.

Fixture Quantity & Mounting Configuration	Single DM19	2 @ 180 DM28	2 @ 90 DM29	3 @ 90 DM39	3 @ 120 DM32	4 @ 90 DM49
Mounting Type						
DSX1 with SPA	0.69	1.38	1.23	1.54	---	1.58
DSX1 with SPA5, SPA8N	0.70	1.40	1.30	1.66	---	1.68
DSX1 with RPA, RPA5	0.70	1.40	1.30	1.66	1.60	1.68
DSX1 with MA	0.83	1.66	1.50	2.09	2.09	2.09

Photometric Diagrams

To see complete photometric reports or download .ies files for this product, visit Lithonia Lighting's [homepage](#).

Isofootcandle plots for the DSX1 LED P9 40K 70CRI. Distances are in units of mounting height (25').

LEGEND

- 0.1 fc
- 0.5 fc
- 1.0 fc

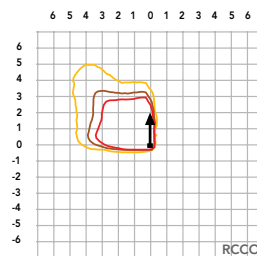
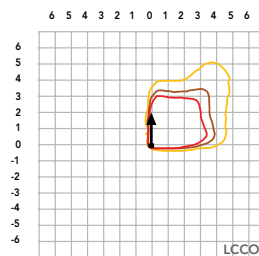
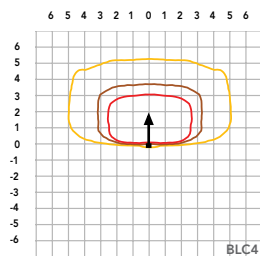
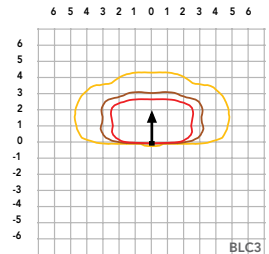
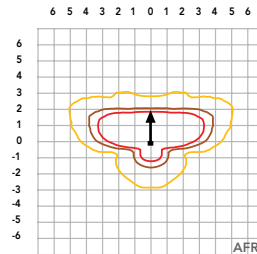
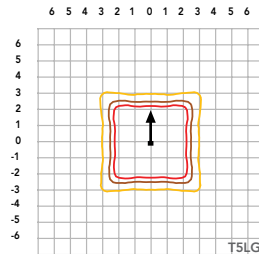
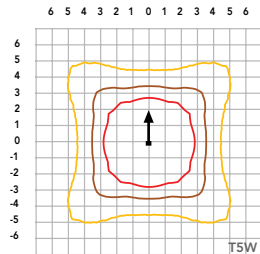
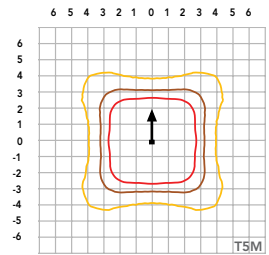
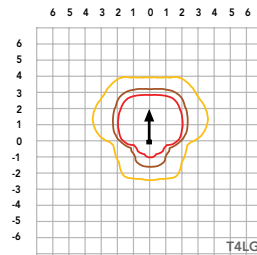
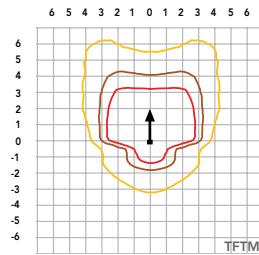
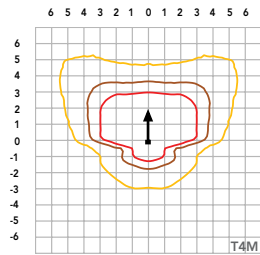
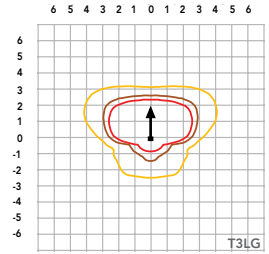
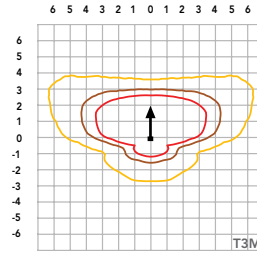
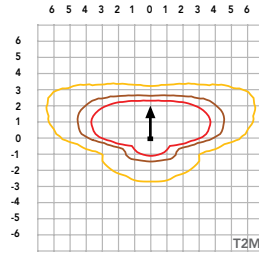
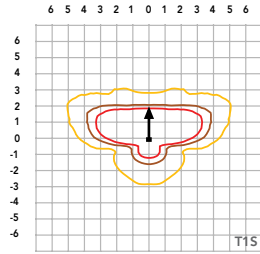

Performance Data

Lumen Ambient Temperature (LAT) Multipliers

Use these factors to determine relative lumen output for average ambient temperatures from 0-40°C (32-104°F).

Ambient		Lumen Multiplier
0°C	32°F	1.04
5°C	41°F	1.04
10°C	50°F	1.03
15°C	59°F	1.02
20°C	68°F	1.01
25°C	77°C	1.00
30°C	86°F	0.99
35°C	95°F	0.98
40°C	104°F	0.97

Projected LED Lumen Maintenance

Data references the extrapolated performance projections for the platforms noted in a **25°C ambient**, based on 10,000 hours of LED testing (tested per IESNA LM-80-08 and projected per IESNA TM-21-11).

To calculate LLF, use the lumen maintenance factor that corresponds to the desired number of operating hours below. For other lumen maintenance values, contact factory.

Operating Hours	Lumen Maintenance Factor
0	1.00
25,000	0.95
50,000	0.90
100,000	0.81

FAO Dimming Settings

FAO Position	% Wattage	% Lumen Output
8	100%	100%
7	93%	95%
6	80%	85%
5	66%	73%
4	54%	61%
3	41%	49%
2	29%	36%
1	15%	20%

*Note: Calculated values are based on original performance package data. When calculating new values for given FAO position, use maximum published values by package listed on specification sheet (input watts and lumens by optic type).

Electrical Load

	Performance Package	LED Count	Drive Current (mA)	Wattage	Current (A)					
					120V	208V	240V	277V	347V	480V
Forward Optics (Non-Rotated)	P1	30	530	51	0.42	0.24	0.21	0.18	0.15	0.11
	P2	30	700	68	0.56	0.33	0.28	0.24	0.20	0.14
	P3	30	1050	104	0.85	0.49	0.43	0.37	0.29	0.21
	P4	30	1250	125	1.03	0.60	0.52	0.45	0.36	0.26
	P5	30	1400	142	1.15	0.66	0.58	0.50	0.40	0.29
	P6	40	1250	167	1.38	0.79	0.69	0.60	0.48	0.34
	P7	40	1400	188	1.54	0.89	0.77	0.67	0.53	0.38
	P8	60	1100	216	1.80	1.04	0.90	0.78	0.62	0.45
	P9	60	1400	279	2.31	1.33	1.15	1.00	0.80	0.58
Rotated Optics (Requires L90 or R90)	P10	60	530	101	0.84	0.49	0.42	0.37	0.29	0.21
	P11	60	700	135	1.12	0.65	0.56	0.49	0.39	0.28
	P12	60	1050	206	1.72	0.99	0.86	0.74	0.59	0.43
	P13	60	1400	279	2.30	1.33	1.15	1.00	0.79	0.57

LED Color Temperature / Color Rendering Multipliers

	70 CRI		80CRI		90CRI	
	Lumen Multiplier	Availability	Lumen Multiplier	Availability	Lumen Multiplier	Availability
5000K	102%	Standard	92%	Extended lead-time	71%	(see note)
4000K	100%	Standard	92%	Extended lead-time	67%	(see note)
3500K	100%	(see note)	90%	Extended lead-time	63%	(see note)
3000K	96%	Standard	87%	Extended lead-time	61%	(see note)
2700K	94%	(see note)	85%	Extended lead-time	57%	(see note)

Note: Some LED types are available as per special request. Contact Technical Support for more information.

Motion Sensor Default Settings

Option	Unoccupied Dimmed Level	High Level (when occupied)	Photocell Operation	Dwell Time	Ramp-up Time	Dimming Fade Rate
PIR	30%	100%	Enabled @ 2FC	7.5 min	3 sec	5 min
NLTAIR2 PIRHN	30%	100%	Enabled @ 2FC	7.5 min	3 sec	5 min

Controls Options

Nomenclature	Description	Functionality	Primary control device	Notes
FAO	Field adjustable output device installed inside the luminaire; wired to the driver dimming leads.	Allows the luminaire to be manually dimmed, effectively trimming the light output.	FAO device	Cannot be used with other controls options that need the 0-10V leads
DS (not available on DSX0)	Drivers wired independently for 50/50 luminaire operation	The luminaire is wired to two separate circuits, allowing for 50/50 operation.	Independently wired drivers	Requires two separately switched circuits. Consider nLight AIR as a more cost effective alternative.
PERS or PER7	Twist-lock photocell receptacle	Compatible with standard twist-lock photocells for dusk to dawn operation, or advanced control nodes that provide 0-10V dimming signals.	Twist-lock photocells such as DLL Elite or advanced control nodes such as ROAM.	Pins 4 & 5 to dimming leads on driver, Pins 6 & 7 are capped inside luminaire. Cannot be used with other controls options that need the 0-10V leads.
PIR	Motion sensor with integral photocell. Sensor suitable for 8' to 40' mounting height.	Luminaires dim when no occupancy is detected.	Acuity Controls rSBG	Cannot be used with other controls options that need the 0-10V leads.
NLTAIR2 PIRHN	nLight AIR enabled luminaire for motion sensing, photocell and wireless communication.	Motion and ambient light sensing with group response. Scheduled dimming with motion sensor over-ride when wirelessly connected to the nLight Elypse.	nLight Air rSBG	nLight AIR sensors can be programmed and commissioned from the ground using the CIAIRity Pro app. Cannot be used with other controls options that need the 0-10V leads.
BL30 or BL50	Integrated bi-level device that allows a second control circuit to switch all light engines to either 30% or 50% light output	BLC device provides input to 0-10V dimming leads on all drivers providing either 100% or dimmed (30% or 50%) control by a secondary circuit	BLC UVOLT1	BLC device is powered off the 0-10V dimming leads, thus can be used with any input voltage from 120 to 480V

Performance Data

Lumen Output

Lumen values are from photometric tests performed in accordance with IESNA LM-79-08. Data is considered to be representative of configurations shown within the tolerances described within LM-79. Contact factory for performance data on any configurations not shown here.

Forward Optics																			
Performance Package	System Watts	LED Count	Drive Current (mA)	Distribution Type	30K					40K					50K				
					(3000K, 70 CRI)					(4000K, 70 CRI)					(5000K, 70 CRI)				
					Lumens	B	U	G	LPW	Lumens	B	U	G	LPW	Lumens	B	U	G	LPW
P1	51W	30	530	T1S	7,776	1	0	2	153	8,104	1	0	2	159	8,262	1	0	2	162
				T2M	7,203	1	0	3	142	7,507	2	0	3	147	7,653	2	0	3	150
				T3M	7,287	1	0	3	143	7,594	1	0	3	149	7,742	1	0	3	152
				T3LG	6,509	1	0	1	128	6,783	1	0	1	133	6,916	1	0	1	136
				T4M	7,395	1	0	3	145	7,707	1	0	3	151	7,857	1	0	3	154
				T4LG	6,726	1	0	1	132	7,010	1	0	1	138	7,146	1	0	1	140
				TFTM	7,446	1	0	3	146	7,760	1	0	3	152	7,912	1	0	3	155
				T5M	7,609	3	0	2	149	7,930	3	0	2	156	8,084	3	0	2	159
				T5W	7,732	3	0	2	152	8,058	4	0	2	158	8,215	4	0	2	161
				T5LG	7,631	3	0	1	150	7,953	3	0	1	156	8,108	3	0	1	159
				BLC3	5,300	0	0	2	104	5,524	0	0	2	109	5,631	0	0	2	111
				BLC4	5,474	0	0	3	108	5,705	0	0	3	112	5,816	0	0	3	114
				RCCO	5,348	0	0	2	105	5,573	0	0	2	109	5,682	0	0	2	112
				LCCO	5,348	0	0	2	105	5,573	0	0	2	109	5,682	0	0	2	112
				AFR	7,776	1	0	2	153	8,104	1	0	2	159	8,262	1	0	2	162
				P2	68W	30	700	T1S	9,997	1	0	2	147	10,418	1	0	2	154	10,621
T2M	9,260	2	0					3	137	9,651	2	0	3	142	9,839	2	0	3	145
T3M	9,368	2	0					3	138	9,763	2	0	3	144	9,953	2	0	3	147
T3LG	8,368	1	0					2	123	8,721	1	0	2	129	8,891	1	0	2	131
T4M	9,507	2	0					3	140	9,909	2	0	3	146	10,102	2	0	3	149
T4LG	8,647	1	0					2	128	9,012	1	0	2	133	9,187	1	0	2	136
TFTM	9,573	2	0					3	141	9,977	2	0	3	147	10,172	2	0	3	150
T5M	9,782	4	0					2	144	10,195	4	0	2	150	10,393	4	0	2	153
T5W	9,940	4	0					2	147	10,360	4	0	2	153	10,562	4	0	2	156
T5LG	9,810	3	0					1	145	10,224	3	0	1	151	10,423	3	0	1	154
BLC3	6,814	0	0					2	101	7,101	0	0	2	105	7,240	0	0	2	107
BLC4	7,038	0	0					3	104	7,334	0	0	3	108	7,477	0	0	3	110
RCCO	6,875	1	0					2	101	7,165	1	0	2	106	7,305	1	0	2	108
LCCO	6,875	1	0					2	101	7,165	1	0	2	106	7,305	1	0	2	108
AFR	9,997	1	0					2	147	10,418	1	0	2	154	10,621	1	0	2	157
P3	102W	30	1050					T1S	14,093	2	0	2	138	14,687	2	0	2	144	14,973
				T2M	13,055	2	0	3	128	13,605	2	0	3	133	13,871	2	0	3	136
				T3M	13,206	2	0	4	129	13,763	2	0	4	135	14,031	2	0	4	137
				T3LG	11,797	2	0	2	115	12,294	2	0	2	120	12,534	2	0	2	123
				T4M	13,403	2	0	4	131	13,968	2	0	4	137	14,241	2	0	4	139
				T4LG	12,190	2	0	2	119	12,704	2	0	2	124	12,952	2	0	2	127
				TFTM	13,496	2	0	4	132	14,065	2	0	4	138	14,339	2	0	4	140
				T5M	13,790	4	0	2	135	14,371	4	0	2	141	14,652	4	0	2	143
				T5W	14,013	4	0	3	137	14,605	4	0	3	143	14,889	4	0	3	146
				T5LG	13,830	3	0	2	135	14,413	3	0	2	141	14,694	3	0	2	144
				BLC3	9,606	0	0	2	94	10,011	0	0	2	98	10,206	0	0	2	100
				BLC4	9,921	0	0	3	97	10,340	0	0	3	101	10,541	0	0	3	103
				RCCO	9,692	1	0	2	95	10,101	1	0	2	99	10,298	1	0	2	101
				LCCO	9,692	1	0	2	95	10,101	1	0	2	99	10,298	1	0	2	101
				AFR	14,093	2	0	2	138	14,687	2	0	2	144	14,973	2	0	2	147

Performance Data

Lumen Output

Lumen values are from photometric tests performed in accordance with IESNA LM-79-08. Data is considered to be representative of configurations shown within the tolerances described within LM-79. Contact factory for performance data on any configurations not shown here.

Forward Optics

Performance Package	System Watts	LED Count	Drive Current (mA)	Distribution Type	30K					40K					50K				
					(3000K, 70 CRI)					(4000K, 70 CRI)					(5000K, 70 CRI)				
					Lumens	B	U	G	LPW	Lumens	B	U	G	LPW	Lumens	B	U	G	LPW
P4	124W	30	1250	T1S	16,416	2	0	3	132	17,109	2	0	3	138	17,442	2	0	3	141
				T2M	15,207	3	0	4	123	15,849	3	0	4	128	16,158	3	0	4	130
				T3M	15,383	2	0	4	124	16,032	2	0	4	129	16,345	2	0	4	132
				T3LG	13,742	2	0	2	111	14,321	2	0	2	116	14,600	2	0	2	118
				T4M	15,613	2	0	4	126	16,272	2	0	4	131	16,589	2	0	4	134
				T4LG	14,200	2	0	2	115	14,799	2	0	2	119	15,087	2	0	2	122
				TFTM	15,721	2	0	4	127	16,384	2	0	4	132	16,703	2	0	4	135
				T5M	16,063	4	0	2	130	16,741	4	0	2	135	17,067	4	0	2	138
				T5W	16,324	5	0	3	132	17,013	5	0	3	137	17,344	5	0	3	140
				T5LG	16,110	3	0	2	130	16,790	4	0	2	135	17,117	4	0	2	138
				BLC3	11,190	0	0	3	90	11,662	0	0	3	94	11,889	0	0	3	96
				BLC4	11,557	0	0	3	93	12,044	0	0	3	97	12,279	0	0	3	99
				RCCO	11,291	1	0	3	91	11,767	1	0	3	95	11,996	1	0	3	97
				LCCO	11,291	1	0	3	91	11,767	1	0	3	95	11,996	1	0	3	97
				AFR	16,416	2	0	3	132	17,109	2	0	3	138	17,442	2	0	3	141
				P5	138W	30	1400	T1S	18,052	2	0	3	131	18,814	2	0	3	136	19,180
T2M	16,723	3	0					4	121	17,428	3	0	4	126	17,768	3	0	4	129
T3M	16,917	3	0					4	122	17,630	3	0	4	128	17,974	3	0	4	130
T3LG	15,111	2	0					2	109	15,749	2	0	2	114	16,055	2	0	2	116
T4M	17,169	3	0					5	124	17,893	3	0	5	130	18,242	3	0	5	132
T4LG	15,615	2	0					2	113	16,274	2	0	2	118	16,591	2	0	2	120
TFTM	17,288	2	0					4	125	18,017	2	0	5	130	18,368	3	0	5	133
T5M	17,664	5	0					3	128	18,410	5	0	3	133	18,768	5	0	3	136
T5W	17,951	5	0					3	130	18,708	5	0	3	135	19,073	5	0	3	138
T5LG	17,716	4	0					2	128	18,463	4	0	2	134	18,823	4	0	2	136
BLC3	12,305	0	0					3	89	12,824	0	0	3	93	13,074	0	0	3	95
BLC4	12,709	0	0					4	92	13,245	0	0	4	96	13,503	0	0	4	98
RCCO	12,416	1	0					3	90	12,940	1	0	3	94	13,192	1	0	3	95
LCCO	12,416	1	0					3	90	12,940	1	0	3	94	13,192	1	0	3	95
AFR	18,052	2	0					3	131	18,814	2	0	3	136	19,180	2	0	3	139
P6	165W	40	1250					T1S	21,031	2	0	3	127	21,918	2	0	3	133	22,345
				T2M	19,482	3	0	4	118	20,303	3	0	4	123	20,699	3	0	4	125
				T3M	19,708	3	0	5	119	20,539	3	0	5	124	20,939	3	0	5	127
				T3LG	17,604	2	0	2	107	18,347	2	0	2	111	18,704	2	0	2	113
				T4M	20,001	3	0	5	121	20,845	3	0	5	126	21,251	3	0	5	129
				T4LG	18,191	2	0	2	110	18,959	2	0	2	115	19,328	2	0	2	117
				TFTM	20,140	3	0	5	122	20,989	3	0	5	127	21,398	3	0	5	129
				T5M	20,579	5	0	3	125	21,447	5	0	3	130	21,865	5	0	3	132
				T5W	20,912	5	0	3	127	21,795	5	0	3	132	22,219	5	0	3	134
				T5LG	20,638	4	0	2	125	21,509	4	0	2	130	21,928	4	0	2	133
				BLC3	14,335	0	0	3	87	14,940	0	0	3	90	15,231	0	0	3	92
				BLC4	14,805	0	0	4	90	15,430	0	0	4	93	15,731	0	0	4	95
				RCCO	14,464	1	0	3	88	15,074	1	0	3	91	15,368	1	0	3	93
				LCCO	14,464	1	0	3	88	15,074	1	0	3	91	15,368	1	0	3	93
				AFR	21,031	2	0	3	127	21,918	2	0	3	133	22,345	2	0	3	135

Performance Data

Lumen Output

Lumen values are from photometric tests performed in accordance with IESNA LM-79-08. Data is considered to be representative of configurations shown within the tolerances described within LM-79. Contact factory for performance data on any configurations not shown here.

Forward Optics																							
Performance Package	System Watts	LED Count	Drive Current (mA)	Distribution Type	30K					40K					50K								
					(3000K, 70 CRI)					(4000K, 70 CRI)					(5000K, 70 CRI)								
					Lumens	B	U	G	LPW	Lumens	B	U	G	LPW	Lumens	B	U	G	LPW				
P7	184W	40	1400	T1S	22,741	2	0	3	123	23,700	2	0	3	129	24,162	3	0	3	131				
				T2M	21,066	3	0	4	114	21,955	3	0	4	119	22,383	3	0	4	121				
				T3M	21,311	3	0	5	116	22,210	3	0	5	120	22,642	3	0	5	123				
				T3LG	19,036	2	0	2	103	19,839	2	0	3	108	20,226	2	0	3	110				
				T4M	21,628	3	0	5	117	22,541	3	0	5	122	22,980	3	0	5	125				
				T4LG	19,671	2	0	2	107	20,501	2	0	3	111	20,900	2	0	3	113				
				TFTM	21,778	3	0	5	118	22,697	3	0	5	123	23,139	3	0	5	125				
				T5M	22,252	5	0	3	121	23,191	5	0	3	126	23,643	5	0	3	128				
				T5W	22,613	5	0	3	123	23,567	5	0	4	128	24,027	5	0	4	130				
				T5LG	22,317	4	0	2	121	23,258	4	0	2	126	23,712	4	0	2	129				
				BLC3	15,501	0	0	3	84	16,155	0	0	4	88	16,470	0	0	4	89				
				BLC4	16,010	0	0	4	87	16,685	0	0	4	90	17,010	0	0	4	92				
				RCCO	15,641	1	0	3	85	16,301	1	0	3	89	16,619	1	0	3	90				
				LCCO	15,641	1	0	3	85	16,301	1	0	3	89	16,619	1	0	3	90				
				AFR	22,741	2	0	3	123	23,700	2	0	3	129	24,162	3	0	3	131				
				P8	216W	60	1100	T1S	28,701	3	0	3	133	29,912	3	0	4	139	30,495	3	0	4	141
								T2M	26,587	3	0	5	123	27,709	3	0	5	128	28,249	3	0	5	131
T3M	26,895	3	0					5	125	28,030	3	0	5	130	28,576	3	0	5	132				
T3LG	24,025	3	0					3	111	25,038	3	0	3	116	25,526	3	0	3	118				
T4M	27,296	3	0					5	127	28,448	3	0	5	132	29,002	3	0	5	134				
T4LG	24,826	3	0					3	115	25,873	3	0	3	120	26,378	3	0	3	122				
TFTM	27,485	3	0					5	127	28,645	3	0	5	133	29,203	3	0	5	135				
T5M	28,084	5	0					4	130	29,269	5	0	4	136	29,839	5	0	4	138				
T5W	28,539	5	0					4	132	29,743	5	0	4	138	30,323	5	0	4	141				
T5LG	28,165	4	0					2	131	29,354	4	0	2	136	29,926	4	0	2	139				
BLC3	19,563	0	0					4	91	20,388	0	0	4	94	20,786	0	0	4	96				
BLC4	20,205	0	0					5	94	21,057	0	0	5	98	21,468	0	0	5	99				
RCCO	19,740	1	0					4	91	20,572	1	0	4	95	20,973	1	0	4	97				
LCCO	19,740	1	0					4	91	20,572	1	0	4	95	20,973	1	0	4	97				
AFR	28,701	3	0					3	133	29,912	3	0	4	139	30,495	3	0	4	141				
P9	277W	60	1400					T1S	34,819	3	0	4	126	36,288	3	0	4	131	36,996	3	0	4	134
								T2M	32,255	3	0	5	116	33,616	3	0	5	121	34,271	3	0	5	124
				T3M	32,629	3	0	5	118	34,006	3	0	5	123	34,668	3	0	5	125				
				T3LG	29,146	3	0	3	105	30,376	3	0	4	110	30,968	3	0	4	112				
				T4M	33,116	3	0	5	120	34,513	3	0	5	125	35,185	3	0	5	127				
				T4LG	30,119	3	0	3	109	31,389	3	0	4	113	32,001	3	0	4	116				
				TFTM	33,345	3	0	5	120	34,751	3	0	5	125	35,429	3	0	5	128				
				T5M	34,071	5	0	4	123	35,509	5	0	4	128	36,201	5	0	4	131				
				T5W	34,624	5	0	4	125	36,084	5	0	4	130	36,788	5	0	4	133				
				T5LG	34,170	5	0	3	123	35,612	5	0	3	129	36,306	5	0	3	131				
				BLC3	23,734	0	0	4	86	24,735	0	0	4	89	25,217	0	0	4	91				
				BLC4	24,513	0	0	5	88	25,547	0	0	5	92	26,045	0	0	5	94				
				RCCO	23,948	1	0	4	86	24,958	1	0	4	90	25,445	1	0	4	92				
				LCCO	23,948	1	0	4	86	24,958	1	0	4	90	25,445	1	0	4	92				
				AFR	34,819	3	0	4	126	36,288	3	0	4	131	36,996	3	0	4	134				

Performance Data

Lumen Output

Lumen values are from photometric tests performed in accordance with IESNA LM-79-08. Data is considered to be representative of configurations shown within the tolerances described within LM-79. Contact factory for performance data on any configurations not shown here.

Rotated Optics																							
Performance Package	System Watts	LED Count	Drive Current (mA)	Distribution Type	30K					40K					50K								
					(3000K, 70 CRI)					(4000K, 70 CRI)					(5000K, 70 CRI)								
					Lumens	B	U	G	LPW	Lumens	B	U	G	LPW	Lumens	B	U	G	LPW				
P10	101W	60	530	T1S	15,164	3	0	3	150	15,803	3	0	3	156	16,112	3	0	3	159				
				T2M	14,047	4	0	4	139	14,640	4	0	4	145	14,925	4	0	4	147				
				T3M	14,208	4	0	4	140	14,807	4	0	4	146	15,096	4	0	4	149				
				T3LG	12,693	3	0	3	125	13,229	3	0	3	131	13,487	3	0	3	133				
				T4M	14,420	4	0	4	142	15,028	4	0	4	148	15,321	4	0	4	151				
				T4LG	13,115	3	0	3	129	13,668	3	0	3	135	13,934	3	0	3	138				
				TFTM	14,522	4	0	4	143	15,134	4	0	4	149	15,429	4	0	4	152				
				T5M	14,836	4	0	2	146	15,462	4	0	2	153	15,763	4	0	2	156				
				T5W	15,076	4	0	3	149	15,712	5	0	3	155	16,019	5	0	3	158				
				T5LG	14,879	3	0	2	147	15,507	3	0	2	153	15,809	3	0	2	156				
				BLC3	10,335	3	0	3	102	10,771	4	0	4	106	10,981	4	0	4	108				
				BLC4	10,674	4	0	4	105	11,124	4	0	4	110	11,341	4	0	4	112				
				RCCO	10,429	1	0	2	103	10,869	1	0	2	107	11,080	1	0	2	109				
				LCCO	10,429	1	0	2	103	10,869	1	0	2	107	11,080	1	0	2	109				
				AFR	15,164	3	0	3	150	15,803	3	0	3	156	16,112	3	0	3	159				
				P11	135W	60	700	T1S	19,437	4	0	4	144	20,257	4	0	4	150	20,651	4	0	4	153
								T2M	18,005	4	0	4	133	18,765	4	0	4	139	19,131	4	0	4	142
T3M	18,211	4	0					4	135	18,980	4	0	4	141	19,350	4	0	4	143				
T3LG	16,270	3	0					3	121	16,957	3	0	3	126	17,287	4	0	4	128				
T4M	18,483	4	0					4	137	19,263	5	0	5	143	19,638	5	0	5	146				
T4LG	16,810	3	0					3	125	17,519	3	0	3	130	17,861	3	0	3	132				
TFTM	18,614	4	0					4	138	19,399	4	0	4	144	19,777	5	0	5	147				
T5M	19,017	5	0					3	141	19,819	5	0	3	147	20,205	5	0	3	150				
T5W	19,325	5	0					3	143	20,140	5	0	3	149	20,533	5	0	3	152				
T5LG	19,072	4	0					2	141	19,876	4	0	2	147	20,264	4	0	2	150				
BLC3	13,247	4	0					4	98	13,806	4	0	4	102	14,075	4	0	4	104				
BLC4	13,682	4	0					4	101	14,259	4	0	4	106	14,537	4	0	4	108				
RCCO	13,367	1	0					3	99	13,931	1	0	3	103	14,203	1	0	3	105				
LCCO	13,367	1	0					3	99	13,931	1	0	3	103	14,203	1	0	3	105				
AFR	19,437	4	0					4	144	20,257	4	0	4	150	20,651	4	0	4	153				
P12	206W	60	1050					T1S	27,457	4	0	4	133	28,616	4	0	4	139	29,174	4	0	4	142
								T2M	25,436	5	0	5	124	26,509	5	0	5	129	27,025	5	0	5	131
				T3M	25,727	5	0	5	125	26,812	5	0	5	130	27,335	5	0	5	133				
				T3LG	22,984	4	0	4	112	23,954	4	0	4	116	24,421	4	0	4	119				
				T4M	26,110	5	0	5	127	27,212	5	0	5	132	27,742	5	0	5	135				
				T4LG	23,747	4	0	4	115	24,749	4	0	4	120	25,231	4	0	4	123				
				TFTM	26,295	5	0	5	128	27,404	5	0	5	133	27,938	5	0	5	136				
				T5M	26,864	5	0	4	130	27,997	5	0	4	136	28,543	5	0	4	139				
				T5W	27,299	5	0	4	133	28,451	5	0	4	138	29,006	5	0	4	141				
				T5LG	26,942	4	0	2	131	28,078	4	0	2	136	28,626	4	0	2	139				
				BLC3	18,714	4	0	4	91	19,504	4	0	4	95	19,884	4	0	4	97				
				BLC4	19,327	5	0	5	94	20,143	5	0	5	98	20,535	5	0	5	100				
				RCCO	18,883	1	0	4	92	19,680	1	0	4	96	20,064	1	0	4	97				
				LCCO	18,883	1	0	4	92	19,680	1	0	4	96	20,064	1	0	4	97				
				AFR	27,457	4	0	4	133	28,616	4	0	4	139	29,174	4	0	4	142				
				P13	276W	60	1400	T1S	34,436	5	0	5	125	35,889	5	0	5	130	36,588	5	0	5	133
								T2M	31,900	5	0	5	116	33,246	5	0	5	121	33,894	5	0	5	123
T3M	32,265	5	0					5	117	33,626	5	0	5	122	34,282	5	0	5	124				
T3LG	28,826	4	0					4	105	30,042	4	0	4	109	30,628	4	0	4	111				
T4M	32,746	5	0					5	119	34,128	5	0	5	124	34,793	5	0	5	126				
T4LG	29,782	4	0					4	108	31,039	4	0	4	113	31,644	5	0	4	115				
TFTM	32,978	5	0					5	120	34,369	5	0	5	125	35,039	5	0	5	127				
T5M	33,692	5	0					4	122	35,113	5	0	4	127	35,797	5	0	4	130				
T5W	34,238	5	0					4	124	35,682	5	0	4	129	36,378	5	0	4	132				
T5LG	33,789	5	0					3	122	35,215	5	0	3	128	35,901	5	0	3	130				
BLC3	23,471	5	0					5	85	24,461	5	0	5	89	24,937	5	0	5	90				
BLC4	24,240	5	0					5	88	25,262	5	0	5	92	25,755	5	0	5	93				
RCCO	23,683	1	0					4	86	24,682	1	0	4	89	25,163	1	0	4	91				
LCCO	23,683	1	0					4	86	24,682	1	0	4	89	25,163	1	0	4	91				
AFR	34,436	5	0					5	125	35,889	5	0	5	130	36,588	5	0	5	133				

Dimensions

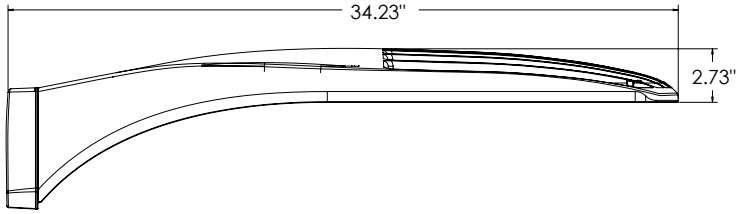

DSX1 with RPA, RPA5, SPA5, SPA8N mount
Weight: 36 lbs

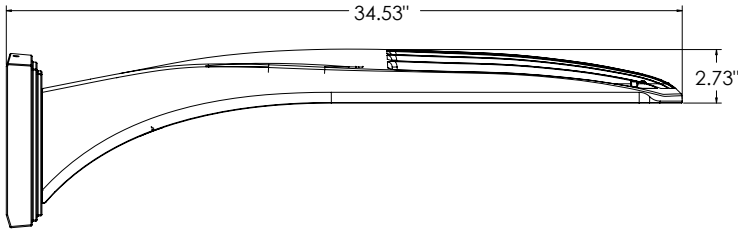
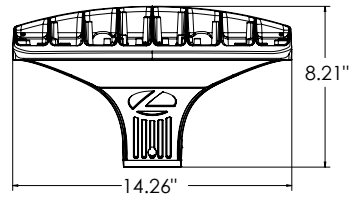

DSX1 with WBA mount
Weight: 38 lbs

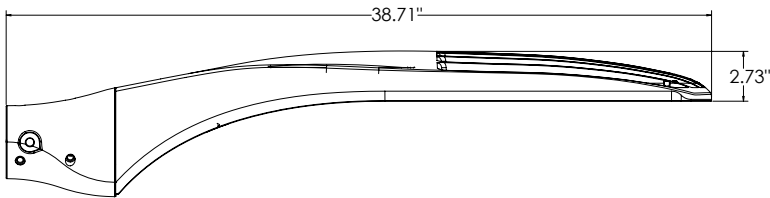
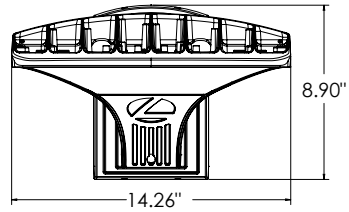

DSX1 with MA mount
Weight: 39 lbs

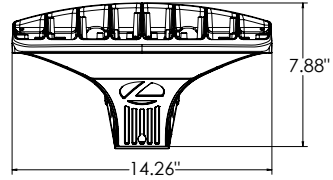

SPA (STANDARD ARM)

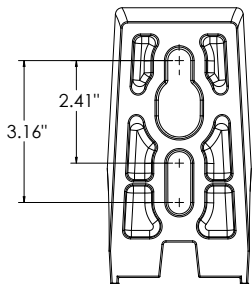

RPA

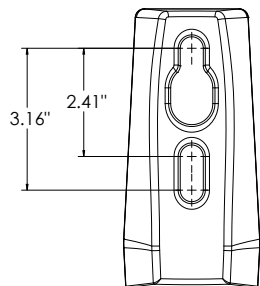

SPA5

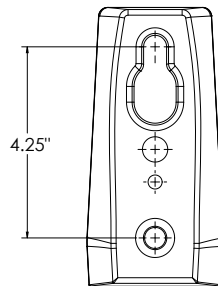

RPA5

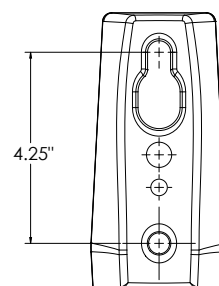

SPA8N

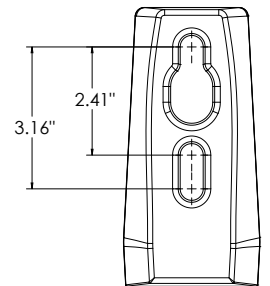

nLight Sensor Coverage Pattern

NLTAIR2 PIRHN

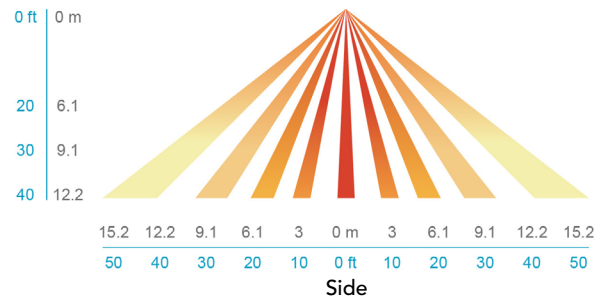
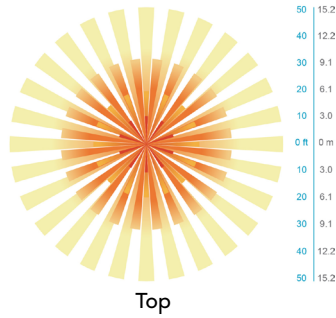

FEATURES & SPECIFICATIONS

INTENDED USE

The sleek design of the D-Series Size 1 reflects the embedded high performance LED technology. It is ideal for many commercial and municipal applications, such as parking lots, plazas, campuses, and streetscapes.

CONSTRUCTION

Single-piece die-cast aluminum housing has integral heat sink fins to optimize thermal management through conductive and convective cooling. Modular design allows for ease of maintenance and future light engine upgrades. The LED drivers are mounted in direct contact with the casting to promote low operating temperature and long life. Housing driver compartment is completely sealed against moisture and environmental contaminants (IP66). Vibration rated per ANSI C136.31 for 3G for SPA and MA. 1.5G for mountings RPA, RPA5, SPA5 and SPA8N. Low EPA (0.69 ft²) for optimized pole wind loading.

FINISH

Exterior parts are protected by a zinc-infused Super Durable TGIC thermoset powder coat finish that provides superior resistance to corrosion and weathering. A tightly controlled multi-stage process ensures a minimum 3 mils thickness for a finish that can withstand extreme climate changes without cracking or peeling. Available in both textured and non-textured finishes.

Coastal Construction (CCE)

Optional corrosion resistant construction is engineered with added corrosion protection in materials and/or pre-treatment of base material under super durable paint. Provides additional corrosion protection for applications near coastal areas. Finish is salt spray tested to over 5,000 hours per ASTM B117 with scribe rating of 10. Additional lead-times may apply.

OPTICS

Precision-molded proprietary silicone lenses are engineered for superior area lighting distribution, uniformity, and pole spacing. Light engines are available in standard 3000 K, 4000 K and 5000 K (70 CRI) configurations. 80CRI configurations are also available. The D-Series Size 1 has zero uplight and qualifies as a Nighttime Friendly™ product, meaning it is consistent with the LEED® and Green Globes™ criteria for eliminating wasteful uplight.

ELECTRICAL

Light engine configurations consist of high-efficacy LEDs mounted to metal-core circuit boards to maximize heat dissipation and promote long life (up to L81/100,000 hours at 25°C). Class 1 electronic drivers are designed to have a power factor >90%, THD <20%, and an expected life of 100,000 hours with <1% failure rate. Easily serviceable 10kV surge protection device meets a minimum Category C Low operation (per ANSI/IEEE C62.41.2).

STANDARD CONTROLS

The DSX1 LED area luminaire has a number of control options. DSX Size 1, comes standard with 0-10V dimming drivers. Dusk to dawn controls can be utilized via optional NEMA twist-lock photocell receptacles. Integrated motion sensor with on-board photocells feature field-adjustable programming and are suitable for mounting heights up to 40 feet. Control option BL features a bi-level device that allows a second control circuit to switch all light engines to either 30% or 50% light output.

nLIGHT AIR CONTROLS

The DSX1 LED area luminaire is also available with nLight® AIR for the ultimate in wireless control. This powerful controls platform provides out-of-the-box basic motion sensing and photocontrol functionality and is suitable for mounting heights up to 40 feet. Once commissioned using a smartphone and the easy-to-use CLAIRITY app, nLight AIR equipped luminaires can be grouped, resulting in motion sensor and photocell group response without the need for additional equipment. Scheduled dimming with motion sensor over-ride can be achieved when used with the nLight Eclipse. Additional information about nLight Air can be found here.

INSTALLATION

Integral mounting arm allows for fast mounting using Lithonia standard #8 drilling and accommodates pole drilling's from 2.41 to 3.12" on center. The standard "SPA" option for square poles and the "RPA" option for round poles use the #8 drilling. For #5 pole drillings, use SPA5 or RPA5. Additional mountings are available including a wall bracket (WBA) and mast arm (MA) option that allows luminaire attachment to a 2 3/8" horizontal mast arm.

LISTINGS

UL listed to meet U.S. and Canadian standards. UL Listed for wet locations. Light engines are IP66 rated; luminaire is IP66 rated. Rated for -40°C minimum ambient.

DesignLights Consortium® (DLC) Premium qualified product and DLC qualified product. Not all versions of this product may be DLC Premium qualified or DLC qualified. Please check the DLC Qualified Products List at www.designlights.org/QPL to confirm which versions are qualified.

International Dark-Sky Association (IDA) Fixture Seal of Approval (FSA) is available for all products on this page utilizing 3000K color temperature only.

GOVERNMENT PROCUREMENT

BAA – Buy America(n) Act: Product with the BAA option qualifies as a domestic end product under the Buy American Act as implemented in the FAR and DFARS. Product with the BAA option also qualifies as manufactured in the United States under DOT Buy America regulations.

BABA – Build America Buy America: Product with the BAA option also qualifies as produced in the United States under the definitions of the Build America, Buy America Act.

Please refer to www.acuitybrands.com/buy-american for additional information.

WARRANTY

5-year limited warranty. This is the only warranty provided and no other statements in this specification sheet create any warranty of any kind. All other express and implied warranties are disclaimed. Complete warranty terms located at: www.acuitybrands.com/support/warranty/terms-and-conditions

Note: Actual performance may differ as a result of end-user environment and application. All values are design or typical values, measured under laboratory conditions at 25 °C. Specifications subject to change without notice.



WPX LED Wall Packs



Catalog Number
Notes
Type

Hit the Tab key or mouse over the page to see all interactive elements.

Specifications

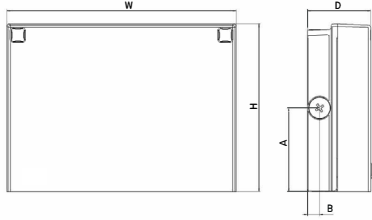

Front View

Side View

Luminaire	Height (H)	Width (W)	Depth (D)	Side Conduit Location		Weight
				A	B	
WPX1	8.1" (20.6 cm)	11.1" (28.3 cm)	3.2" (8.1 cm)	4.0" (10.3 cm)	0.6" (1.6 cm)	6.1 lbs (2.8kg)
WPX2	9.1" (23.1 cm)	12.3" (31.1 cm)	4.1" (10.5 cm)	4.5" (11.5 cm)	0.7" (1.7 cm)	8.2 lbs (3.7kg)
WPX3	9.5" (24.1 cm)	13.0" (33.0 cm)	5.5" (13.7 cm)	4.7" (12.0 cm)	0.7" (1.7 cm)	11.0 lbs (5.0kg)

Introduction

The WPX LED wall packs are energy-efficient, cost-effective, and aesthetically appealing solutions for both HID wall pack replacement and new construction opportunities. Available in three sizes, the WPX family delivers 1,550 to 9,200 lumens with a wide, uniform distribution.

The WPX full cut-off solutions fully cover the footprint of the HID glass wall packs that they replace, providing a neat installation and an upgraded appearance. Reliable IP66 construction and excellent LED lumen maintenance ensure a long service life. Photocell and emergency egress battery options make WPX ideal for every wall mounted lighting application.

Ordering Information

EXAMPLE: WPX2 LED 40K MVOLT DDBXD

Series	Color Temperature	Voltage	Options	Finish
WPX1 LED P1	30K 3000K	MVOLT 120V - 277V	(blank) None	DDBXD Dark bronze
WPX1 LED P2	40K 4000K	347 347V ³	E4WH Emergency battery backup, CEC compliant (4W, 0°C min) ²	DWHXD White
WPX2 LED	50K 5000K		E14WC Emergency battery backup, CEC compliant (14W, -20°C min) ²	DBLXD Black
WPX3 LED			PE Photocell ³	Note : For other options, consult factory.

Note: The lumen output and input power shown in the ordering tree are average representations of all configuration options. Specific values are available on request.

NOTES

- All WPX wall packs come with 6kV surge protection standard, except WPX1 LED P1 package which comes with 2.5kV surge protection standard. Add SPD6KV option to get WPX1 LED P1 with 6kV surge protection. Sample nomenclature: WPX1 LED P1 40K MVOLT SPD6KV DDBXD
- Battery pack options only available on WPX1 and WPX2.
- Battery pack options not available with 347V or PE options.

FEATURES & SPECIFICATIONS

INTENDED USE

The WPX LED wall packs are designed to provide a cost-effective, energy-efficient solution for the one-for-one replacement of existing HID wall packs. The WPX1, WPX2 and WPX3 are ideal for replacing up to 150W, 250W, and 400W HID luminaires respectively. WPX luminaires deliver a uniform, wide distribution. WPX is rated for -40°C to 40°C.

CONSTRUCTION

WPX feature a die-cast aluminum main body with optimal thermal management that both enhances LED efficacy and extends component life. The luminaires are IP66 rated, and sealed against moisture or environmental contaminants.

ELECTRICAL

Light engine(s) configurations consist of high-efficacy LEDs and LED lumen maintenance of L90/100,000 hours. Color temperature (CCT) options of 3000K, 4000K and 5000K with minimum CRI of 70. Electronic drivers ensure system power factor >90% and THD <20%. All luminaires have 6kV surge protection (Note: WPX1 LED P1 package comes with a standard surge protection rating of 2.5kV. It can be ordered with an optional 6kV surge protection). All photocell (PE) operate on MVOLT (120V - 277V) input.

Note: The standard WPX LED wall pack luminaires come with field-adjustable drive current feature. This feature allows tuning the output current of the LED drivers to adjust the lumen output (to dim the luminaire).

INSTALLATION

WPX can be mounted directly over a standard electrical junction box. Three 1/2 inch conduit ports on three sides allow for surface conduit wiring. A port on the back surface allows poke-through conduit wiring on surfaces that don't have an electrical junction box. Wiring can be made in the integral wiring compartment in all cases. WPX is only recommended for installations with LEDs facing downwards. The WPX is intended for installation on flat wall surfaces. Other applications may void warranty.

LISTINGS

CSA Certified to meet U.S. and Canadian standards. Suitable for wet locations. IP66 Rated. DesignLights Consortium® (DLC) qualified product. Not all versions of this product may be DLC qualified. Please check the DLC Qualified Products List at www.designlights.org/QPL to confirm which versions are qualified. International Dark Sky Association (IDA) Fixture Seal of Approval (FSA) is available for all products on this page utilizing 3000K color temperature only.

WARRANTY

5-year limited warranty. This is the only warranty provided and no other statements in this specification sheet create any warranty of any kind. All other express and implied warranties are disclaimed. Complete warranty terms located at: www.acuitybrands.com/support/warranty/terms-and-conditions.

Note: Actual performance may differ as a result of end-user environment and application. All values are design or typical values, measured under laboratory conditions at 25°C. Specifications subject to change without notice.



Performance Data

Electrical Load

Luminaire	Input Power (W)	120V	208V	240V	277V	347V
WPX1 LED P1	11W	0.09	0.05	0.05	0.04	0.03
WPX1 LED P2	24W	0.20	0.12	0.10	0.09	0.07
WPX2	47W	0.39	0.23	0.20	0.17	0.14
WPX3	69W	0.58	0.33	0.29	0.25	0.20

Projected LED Lumen Maintenance

Data references the extrapolated performance projections in a 25°C ambient, based on 6,000 hours of LED testing (tested per IESNA LM-80-08 and projected per IESNA TM-21-11).

To calculate LLF, use the lumen maintenance factor that corresponds to the desired number of operating hours below. For other lumen maintenance values, contact factory.

Operating Hours	50,000	75,000	100,000
Lumen Maintenance Factor	>0.94	>0.92	>0.90

Lumen Output

Luminaire	Color Temperature	Lumen Output
WPX1 LED P1	3000K	1,537
	4000K	1,568
	5000K	1,602
WPX1 LED P2	3000K	2,748
	4000K	2,912
	5000K	2,954
WPX2	3000K	5,719
	4000K	5,896
	5000K	6,201
WPX3	3000K	8,984
	4000K	9,269
	5000K	9,393

Lumen Ambient Temperature (LAT) Multipliers

Use these factors to determine relative lumen output for average ambient temperatures from 0-40°C (32-104°F).

Ambient	Ambient	Lumen Multiplier
0°C	32°F	1.05
5°C	41°F	1.04
10°C	50°F	1.03
15°C	59°F	1.02
20°C	68°F	1.01
25°C	77°F	1.00
30°C	86°F	0.99
35°C	95°F	0.98
40°C	104°F	0.97

HID Replacement Guide

Luminaire	Equivalent HID Lamp	WPX Input Power
WPX1 LED P1	100W	11W
WPX1 LED P2	150W	24W
WPX2	250W	47W
WPX3	400W	69W

Emergency Egress Battery Packs

The emergency battery backup is integral to the luminaire — no external housing or back box is required. The emergency battery will power the luminaire for a minimum duration of 90 minutes and deliver minimum initial output of 550 lumens. Both battery pack options are CEC compliant.

Battery Type	Minimum Temperature Rating	Power (Watts)	Controls Option	Ordering Example
Standard	0°C	4W	E4WH	WPX2 LED 40K MVOLT E4WH DDBXD
Cold Weather	-20°C	14W	E14WC	WPX2 LED 40K MVOLT E14WC DDBXD

Photometric Diagrams

To see complete photometric reports or download .ies files for this product, visit the Lithonia Lighting [WPX LED](#) homepage. Tested in accordance with IESNA LM-79 and LM-80 standards

LEGEND

	0.1 fc
	0.2 fc
	0.5 fc
	1.0 fc

WPX1 LED P1

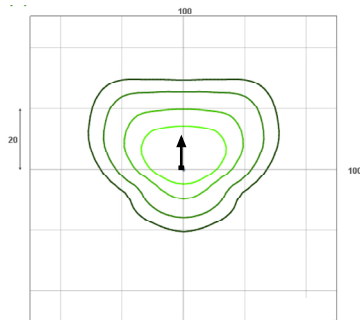

WPX1 LED P2

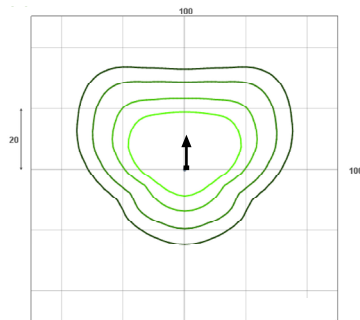

WPX2 LED

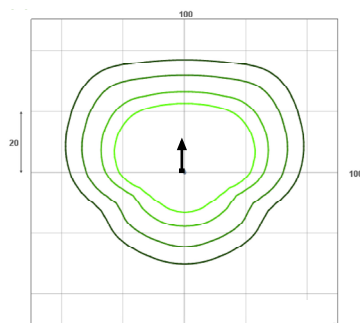

WPX3 LED

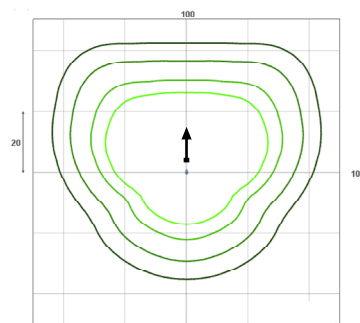

Mounting Height = 12 Feet.



WPX LED Wall Packs



Catalog Number
Notes
Type

Hit the Tab key or mouse over the page to see all interactive elements.

Specifications

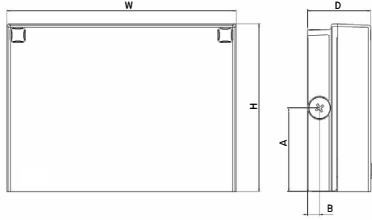

Front View

Side View

Luminaire	Height (H)	Width (W)	Depth (D)	Side Conduit Location		Weight
				A	B	
WPX1	8.1" (20.6 cm)	11.1" (28.3 cm)	3.2" (8.1 cm)	4.0" (10.3 cm)	0.6" (1.6 cm)	6.1 lbs (2.8kg)
WPX2	9.1" (23.1 cm)	12.3" (31.1 cm)	4.1" (10.5 cm)	4.5" (11.5 cm)	0.7" (1.7 cm)	8.2 lbs (3.7kg)
WPX3	9.5" (24.1 cm)	13.0" (33.0 cm)	5.5" (13.7 cm)	4.7" (12.0 cm)	0.7" (1.7 cm)	11.0 lbs (5.0kg)

Introduction

The WPX LED wall packs are energy-efficient, cost-effective, and aesthetically appealing solutions for both HID wall pack replacement and new construction opportunities. Available in three sizes, the WPX family delivers 1,550 to 9,200 lumens with a wide, uniform distribution.

The WPX full cut-off solutions fully cover the footprint of the HID glass wall packs that they replace, providing a neat installation and an upgraded appearance. Reliable IP66 construction and excellent LED lumen maintenance ensure a long service life. Photocell and emergency egress battery options make WPX ideal for every wall mounted lighting application.

Ordering Information

EXAMPLE: WPX2 LED 40K MVOLT DDBXD

Series	Color Temperature	Voltage	Options	Finish
WPX1 LED P1	30K 3000K	MVOLT 120V - 277V	(blank) None	DDBXD Dark bronze
WPX1 LED P2	40K 4000K	347 347V ³	E4WH Emergency battery backup, CEC compliant (4W, 0°C min) ²	DWHXD White
WPX2 LED	50K 5000K		E14WC Emergency battery backup, CEC compliant (14W, -20°C min) ²	DBLXD Black
WPX3 LED			PE Photocell ³	Note : For other options, consult factory.

Note: The lumen output and input power shown in the ordering tree are average representations of all configuration options. Specific values are available on request.

NOTES

- All WPX wall packs come with 6kV surge protection standard, except WPX1 LED P1 package which comes with 2.5kV surge protection standard. Add SPD6KV option to get WPX1 LED P1 with 6kV surge protection. Sample nomenclature: WPX1 LED P1 40K MVOLT SPD6KV DDBXD
- Battery pack options only available on WPX1 and WPX2.
- Battery pack options not available with 347V or PE options.

FEATURES & SPECIFICATIONS

INTENDED USE

The WPX LED wall packs are designed to provide a cost-effective, energy-efficient solution for the one-for-one replacement of existing HID wall packs. The WPX1, WPX2 and WPX3 are ideal for replacing up to 150W, 250W, and 400W HID luminaires respectively. WPX luminaires deliver a uniform, wide distribution. WPX is rated for -40°C to 40°C.

CONSTRUCTION

WPX feature a die-cast aluminum main body with optimal thermal management that both enhances LED efficacy and extends component life. The luminaires are IP66 rated, and sealed against moisture or environmental contaminants.

ELECTRICAL

Light engine(s) configurations consist of high-efficacy LEDs and LED lumen maintenance of L90/100,000 hours. Color temperature (CCT) options of 3000K, 4000K and 5000K with minimum CRI of 70. Electronic drivers ensure system power factor >90% and THD <20%. All luminaires have 6kV surge protection (Note: WPX1 LED P1 package comes with a standard surge protection rating of 2.5kV. It can be ordered with an optional 6kV surge protection). All photocell (PE) operate on MVOLT (120V - 277V) input.

Note: The standard WPX LED wall pack luminaires come with field-adjustable drive current feature. This feature allows tuning the output current of the LED drivers to adjust the lumen output (to dim the luminaire).

INSTALLATION

WPX can be mounted directly over a standard electrical junction box. Three 1/2 inch conduit ports on three sides allow for surface conduit wiring. A port on the back surface allows poke-through conduit wiring on surfaces that don't have an electrical junction box. Wiring can be made in the integral wiring compartment in all cases. WPX is only recommended for installations with LEDs facing downwards. The WPX is intended for installation on flat wall surfaces. Other applications may void warranty.

LISTINGS

CSA Certified to meet U.S. and Canadian standards. Suitable for wet locations. IP66 Rated. DesignLights Consortium® (DLC) qualified product. Not all versions of this product may be DLC qualified. Please check the DLC Qualified Products List at www.designlights.org/QPL to confirm which versions are qualified. International Dark Sky Association (IDA) Fixture Seal of Approval (FSA) is available for all products on this page utilizing 3000K color temperature only.

WARRANTY

5-year limited warranty. This is the only warranty provided and no other statements in this specification sheet create any warranty of any kind. All other express and implied warranties are disclaimed. Complete warranty terms located at: www.acuitybrands.com/support/warranty/terms-and-conditions.

Note: Actual performance may differ as a result of end-user environment and application. All values are design or typical values, measured under laboratory conditions at 25°C. Specifications subject to change without notice.



Performance Data

Electrical Load

Luminaire	Input Power (W)	120V	208V	240V	277V	347V
WPX1 LED P1	11W	0.09	0.05	0.05	0.04	0.03
WPX1 LED P2	24W	0.20	0.12	0.10	0.09	0.07
WPX2	47W	0.39	0.23	0.20	0.17	0.14
WPX3	69W	0.58	0.33	0.29	0.25	0.20

Projected LED Lumen Maintenance

Data references the extrapolated performance projections in a 25°C ambient, based on 6,000 hours of LED testing (tested per IESNA LM-80-08 and projected per IESNA TM-21-11).

To calculate LLF, use the lumen maintenance factor that corresponds to the desired number of operating hours below. For other lumen maintenance values, contact factory.

Operating Hours	50,000	75,000	100,000
Lumen Maintenance Factor	>0.94	>0.92	>0.90

Lumen Output

Luminaire	Color Temperature	Lumen Output
WPX1 LED P1	3000K	1,537
	4000K	1,568
	5000K	1,602
WPX1 LED P2	3000K	2,748
	4000K	2,912
	5000K	2,954
WPX2	3000K	5,719
	4000K	5,896
	5000K	6,201
WPX3	3000K	8,984
	4000K	9,269
	5000K	9,393

Lumen Ambient Temperature (LAT) Multipliers

Use these factors to determine relative lumen output for average ambient temperatures from 0-40°C (32-104°F).

Ambient	Ambient	Lumen Multiplier
0°C	32°F	1.05
5°C	41°F	1.04
10°C	50°F	1.03
15°C	59°F	1.02
20°C	68°F	1.01
25°C	77°F	1.00
30°C	86°F	0.99
35°C	95°F	0.98
40°C	104°F	0.97

HID Replacement Guide

Luminaire	Equivalent HID Lamp	WPX Input Power
WPX1 LED P1	100W	11W
WPX1 LED P2	150W	24W
WPX2	250W	47W
WPX3	400W	69W

Emergency Egress Battery Packs

The emergency battery backup is integral to the luminaire — no external housing or back box is required. The emergency battery will power the luminaire for a minimum duration of 90 minutes and deliver minimum initial output of 550 lumens. Both battery pack options are CEC compliant.

Battery Type	Minimum Temperature Rating	Power (Watts)	Controls Option	Ordering Example
Standard	0°C	4W	E4WH	WPX2 LED 40K MVOLT E4WH DDBXD
Cold Weather	-20°C	14W	E14WC	WPX2 LED 40K MVOLT E14WC DDBXD

Photometric Diagrams

To see complete photometric reports or download .ies files for this product, visit the Lithonia Lighting [WPX LED](#) homepage. Tested in accordance with IESNA LM-79 and LM-80 standards

LEGEND

	0.1 fc
	0.2 fc
	0.5 fc
	1.0 fc

WPX1 LED P1

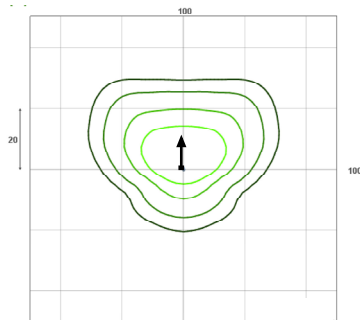

WPX1 LED P2

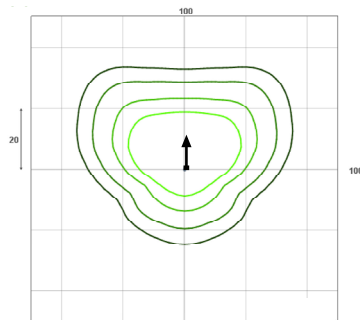

WPX2 LED

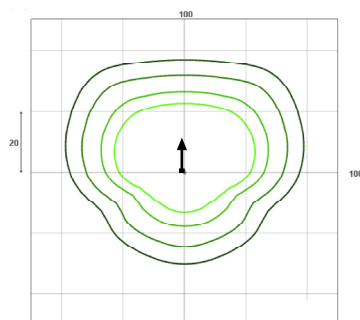

WPX3 LED

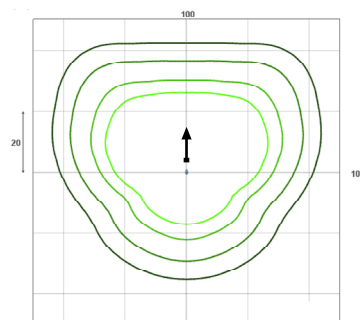

Mounting Height = 12 Feet.



D-Series LED Bollard



d#series

Specifications

Diameter: 8" Round
(20.3 cm)

Height: 42"
(106.7 cm)

Weight (max): 27 lbs
(12.25 kg)



Catalog
Number

Notes

Type

Hit the Tab key or mouse over the page to see all interactive elements.

Introduction

The D-Series LED Bollard is a stylish, energy-saving, long-life solution designed to perform the way a bollard should—with zero uplift. An optical leap forward, this full cut-off luminaire will meet the most stringent of lighting codes. The D-Series LED Bollard's rugged construction, durable finish and long-lasting LEDs will provide years of maintenance-free service.

Ordering Information

EXAMPLE: DSXB LED 16C 700 40K SYM MVOLT DDBXD

DSXB LED												
Series	LEDs	Drive current		Color temperature		Distribution		Voltage	Control options	Other options	Finish <i>(required)</i>	
DSXB LED	Asymmetric 12C 12 LEDs ¹	350	350 mA	30K	3000 K	ASY	Asymmetric ¹	MVOLT ⁵	Shipped installed PE Photoelectric cell, button type DMG 00-10v dimming wires pulled outside fixture (for use with an external control, ordered separately) ELCW Emergency battery backup ⁶	Shipped installed SF Single fuse (120, 277, 347V) ^{4,7} DF Double fuse (208, 240V) ^{4,7} H24 24" overall height H30 30" overall height H36 36" overall height FG Ground-fault festoon outlet L/AB Without anchor bolts L/AB4 4-bolt retrofit base without anchor bolts ⁸	DWHXD	White
		450	450 mA ^{3,4}	40K	4000 K	SYM	Symmetric ²	120 ⁵			DNAXD	Natural aluminum
	530	530 mA	50K	5000 K			208 ⁵	DDBXD			Dark bronze	
	700	700 mA	AMBPC	Amber phosphor converted			240 ⁵	DBLXD			Black	
	Symmetric 16C 16 LEDs ²			AMBLW	Amber limited wavelength ^{3,4}			277 ⁵			DDBTXD	Textured dark bronze
							347 ⁴	DBLBXD	Textured black	DNATXD	Textured natural aluminum	
											DWHGXD	Textured white

Accessories

Ordered and shipped separately.

MRAB U Anchor bolts for DSXB⁸

NOTES

- 1 Only available in the 12C, ASY version.
- 2 Only available in the 16C, SYM version.
- 3 Only available with 450 AMBLW version.
- 4 Not available with ELCW.
- 5 MVOLT driver operates on any line voltage from 120-277V (50/60 Hz). Specify 120, 208, 240 or 277 options only when ordering with fusing (SF, DF options), or photocontrol (PE option).
- 6 Not available with 347V. Not available with fusing. Not available with 450 AMBLW.
- 7 Single fuse (SF) requires 120, 277, or 347 voltage option. Double fuse (DF) requires 208 or 240 voltage option.
- 8 MRAB U not available with L/AB4 option.



Performance Data

Lumen values are from photometric tests performed in accordance with IESNA LM-79-08. Data is considered to be representative of the configurations shown, within the tolerances allowed by Lighting Facts. Actual performance may differ as a result of end-user environment and application. Actual wattage may differ by +/- 8% when operating between 120-480V +/- 10%.

Light Engines	Drive Current	System Watts	3000 K					4000 K					5000 K					Limited Wavelength Amber					
			Lumens	LPW	B	U	G	Lumens	LPW	B	U	G	Lumens	LPW	B	U	G	Lumens	LPW	B	U	G	
Asymmetric (12 LEDs)	350	16	1,194	75	1	0	1	1,283	80	1	0	1	1,291	81	1	0	1						
	530	22	1,719	78	1	0	1	1,847	84	1	0	1	1,859	85	1	0	1						
	700	31	2,173	70	1	0	1	2,335	75	1	0	1	2,349	76	1	0	1						
	Amber 450	16																348	22	1	0	1	
Symmetric (16 LEDs)	350	20	1,558	78	1	0	0	1,674	84	1	0	0	1,685	84	1	0	0						
	530	28	2,232	80	2	0	1	2,397	86	2	0	1	2,412	86	2	0	1						
	700	39	2,802	72	2	0	1	3,009	77	2	0	1	3,028	78	2	0	1						
	Amber 450	20																419	21	1	0	1	

Note: Available with phosphor-converted amber LED's (nomenclature AMBPC). These LED's produce light with 97+% >530 nm. Output can be calculated by applying a 0.7 factor to 4000 K lumen values and photometric files.

Projected LED Lumen Maintenance

Data references the extrapolated performance projections for the platforms noted in a **25°C ambient**, based on 10,000 hours of LED testing (tested per IESNA LM-80-08 and projected per IESNA TM-21-11).

To calculate LLF, use the lumen maintenance factor that corresponds to the desired number of operating hours below. For other lumen maintenance values, contact factory.

Operating Hours	0	25,000	50,000	100,000
Lumen Maintenance Factor	1.00	0.98	0.97	0.95

Electrical Load

Light Engines	Drive Current (mA)	System Watts	Current (A)				
			120	208	240	277	347
12C	350	16W	0.158	0.118	0.114	0.109	0.105
	530	22W	0.217	0.146	0.136	0.128	0.118
	700	31W	0.296	0.185	0.168	0.153	0.139
	Amber 450	16W	0.161	0.120	0.115	0.110	0.106
16C	350	20W	0.197	0.137	0.128	0.121	0.114
	530	28W	0.282	0.178	0.162	0.148	0.135
	700	39W	0.385	0.231	0.207	0.185	0.163
	Amber 450	20W	0.199	0.139	0.130	0.123	0.116

Photometric Diagrams

To see complete photometric reports or download .ies files for this product, visit Lithonia Lighting's [D-Series Bollard homepage](#).

Isfootcandle plots for the DSXB LED 700 40K. Distances are in units of mounting height (3').

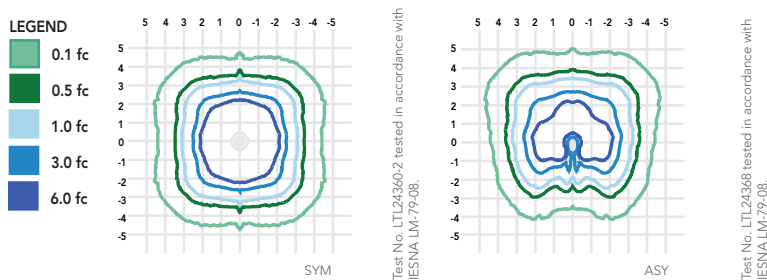

FEATURES & SPECIFICATIONS

INTENDED USE

The rugged construction and maintenance-free performance of the D-Series LED Bollard is ideal for illuminating building entryways, walking paths and pedestrian plazas, as well as any other location requiring a low-mounting-height light source.

CONSTRUCTION

One-piece 8-inch-round extruded aluminum shaft with thick side walls for extreme durability, and die-cast aluminum reflector and top cap. Die-cast aluminum mounting ring allows for easy leveling even in uneven areas and full 360-degree rotation for precise alignment during installation. Three 1/2" x 11" anchor bolts with double nuts and washers and 3-5/8" max. bolt circle template ensure stability. Overall height is 42" standard.

FINISH

Exterior parts are protected by a zinc-infused super durable TGIC thermoset powder coat finish that provides superior resistance to corrosion and weathering for maximum retention of gloss and luster. A tightly controlled multi-stage process ensures a minimum 3-mil thickness for a finish that can withstand the elements without cracking or peeling. Available in both textured and non-textured finishes.

OPTICS

Two 0% uplight optical distributions are available: symmetrical and asymmetrical. IP66 sealed LED light engine provides smoothly graduated illumination without uplight. Light engines are available in standard 4000 K (>70 CRI) or optional 3000 K (>80 CRI) or 5000 K (67 CRI). Limited-wavelength amber LEDs are also available.

ELECTRICAL

Light engines consist of high-efficiency LEDs mounted to metal-core circuit boards to maximize heat dissipation and promote long life (L95/100,000 hours at 700mA at 25°C). Class 2 electronic drivers are designed for an expected life of 100,000 hours with < 1% failure rate. Electrical components are mounted on a removable power tray.

LISTINGS

CSA certified to U.S. and Canadian standards. Light engines are IP66 rated. Rated for -40°C minimum ambient. Cold-weather emergency battery backup rated for -20°C minimum ambient.

GOVERNMENT PROCUREMENT

BAA – Buy America(n) Act: Product qualifies as a domestic end product under the Buy American Act as implemented in the FAR and DFARS. Product also qualifies as manufactured in the United States under DOT Buy America regulations.

BABA – Build America Buy America: Product qualifies as produced in the United States under the definitions of the Build America, Buy America Act. Please refer to www.acuitybrands.com/buy-american for additional information.

WARRANTY

Five-year limited warranty. This is the only warranty provided and no other statements in this specification sheet create any warranty of any kind. All other express and implied warranties are disclaimed. Complete warranty terms located at: www.acuitybrands.com/CustomResources/Terms_and_conditions.aspx.

Note: Actual performance may differ as a result of end-user environment and application. All values are design or typical values, measured under laboratory conditions at 25 °C. Specifications subject to change without notice.

