

M A I N R O A D

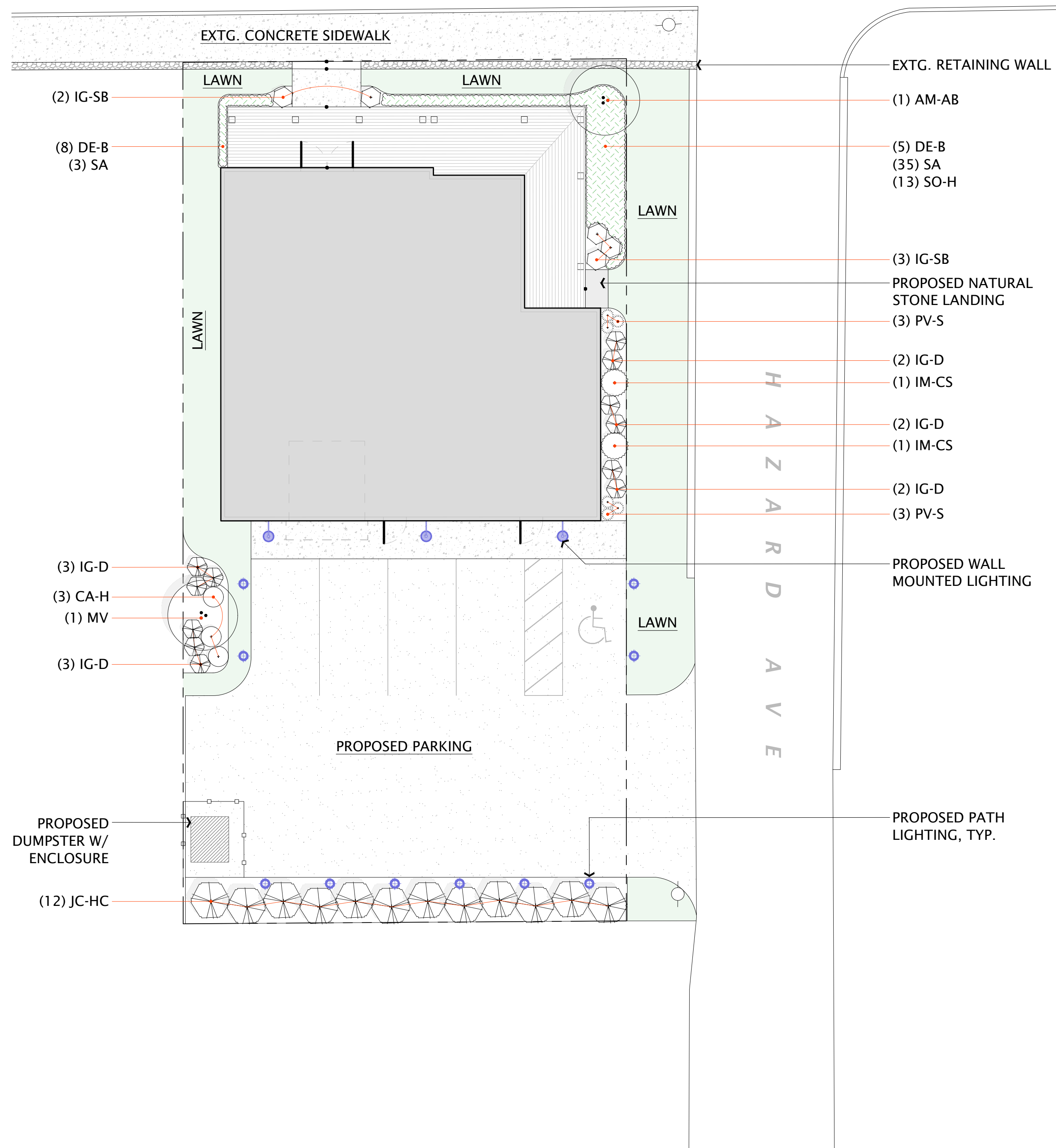

PLANT SCHEDULE:

QTY.	SYMB.	BOTANICAL NAME	COMMON NAME	SIZE	ROOT BALL	COMMENT
<b>TREES</b>						
1	AM-AB	Amelanchier x grandiflora 'Autumn Brilliance'	Serviceberry	5/6' ht.	B&B	10' O.C.
12	JC-HC	Juniperus chinensis 'Hetzii Columnaris'	Hetz columnar juniper	6/7' ht.	B&B	5' O.C.
1	MV	Magnolia virginiana	Sweetbay magnolia	7/8' ht.	B&B	10' O.C.
<b>SHRUBS</b>						
3	CA-H	Clethra alnifolia 'Hummingbird'	Summersweet	3 gal.	Container	3' O.C.
12	IG-D	Ilex glabra 'Densa'	Inkberry	3 gal.	Container	30" O.C.
5	IG-SB	Ilex glabra 'Strongbox'	Inkberry	3 gal.	Container	28" O.C.
2	IM-CS	Ilex x meserveae 'Castle Spire'	Castle spire holly	5 gal.	Container	42" O.C.
<b>PERENNIALS and ORNAMENTAL GRASSES</b>						
13	DE-B	Dryopteris erythrosora 'Brilliance'	Brilliance autumn fern	1 gal.	Container	18" O.C.
6	PV-S	Panicum virgatum 'Shenandoah'	Shenandoah switchgrass	1 gal.	Container	18" O.C.
38	SA	Sesleria autumnalis	Autumn moor grass	1 gal.	Container	20" O.C.
13	SO-H	Stachys officinalis 'Hummelo'	Betony	1 gal.	Container	18" O.C.

LIGHTING:



PATH LIGHT: Flexi-Glow Dual-Head  
Outdoor Lawn Light  
GU10 lamp cut  
Warm White (3000K)  
85-265V Voltage  
86-161 SF Illumination Space  
18" ht.

WALL MOUNTED LIGHT: Hinkley Forge  
Outdoor Barn Wall Light  
17 1/2" high X 16" wide  
Extends 32 1/2" from wall  
14W E26 Standard-medium LED bulb  
120V



AMELANCHIER 'AUTUMN BRILLIANCE'



JUNIPERUS 'HETZII COLUMNARIS'



MAGNOLIA VIRGINIANA



CLETHRA 'HUMMINGBIRD'



ILEX 'DENSE'



ILEX 'STRONGBOX'



ILEX 'CASTLE SPIRE'



DRYOPTERIS 'BRILLIANCE'



PANICUM 'SHENANDOAH'



SESLERIA AUTUMNALIS



STACHYS 'HUMMELO'

SHEET:  
**L1.0**

PRELIMINARY  
LANDSCAPE  
PLAN

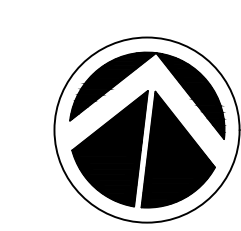

DATE:  
5/28/25  
SCALE:  
1"=10'-0"

REVISIONS:  
10/20/25

N E I L L B R O T H E R S  
8 2 M A I N S T R E E T S O U T H K I N G S T O W N , R I 0 2 8 7 9

